

Name of Meeting: District Committee – Kirklees Rural Public Meeting

Date: 25 February 2017

Title of Report: Devolved Budgets – Projects and Proposals for Expenditure

Is it likely to result in spending or saving £250k or more, or to have a significant effect on two or more electoral wards?	Not applicable
Is it in the Council's Forward Plan?	Not applicable
Is it eligible for “call in” by Scrutiny?	Yes
Date signed off by <u>Director</u> and name	Carol Gilchrist – Head of Safe and Cohesive Communities/ Kim Brear, Assistant Director Streetscene & Housing
Is it signed off by the Director of Resources?	No
Is it signed off by the Assistant Director – Legal, Governance and Monitoring?	No
Cabinet member portfolio	Community Development, Councillor Involvement in New Council

Electoral Wards Affected: Denby Dale, Kirkburton, Colne Valley, Golcar, Holme Valley North, Holme Valley South

Ward Councillors Consulted: All

Public or Private: Public

1. Purpose of the report

The report outlines the budget balances and the funding proposals for decision at the next public meeting.

2. Key points

2.1 The devolved budgets enable the District Committee to develop activities and interventions tailored to the needs of the district under agreed priority themes.

2.2 Priority Themes

Kirklees Rural District Committee has agreed the following priority themes:

Early Intervention and Prevention:

Tackling issues early to delay or prevent bigger problems from occurring.

Economic Resilience:

Building resilient communities where people are skilled and have economic opportunities.

2.3 Delegated Budgets:

District Committee budget balances are as follows:

• Capital	-	£13,983.27
• Revenue	-	£94,701.37
• New Homes Bonus	-	£220,987.00

Appendix 1	-	project summaries
Report 1 -	-	detailed project reports
Appendix 2	-	budget breakdown

2.4 Fast Track Commissions and Discretionary Grants

Any urgent grants under £500 and commissions under £1,000 supported by Councillors, the Chair of the District Committee and approved by the Head of Safe and Cohesive Communities since the last District Committee meeting to be noted on the decision summary:

£500 revenue – CCTV – Holme Valley North Ward - (approved 15.12.2016) – **Fast Track Commission. Proposed change of use** – work with young girls group at Honley High School, diversionary activity April 2017

£205 revenue - Milnsbridge Village Hall – Christmas Lunch – Golcar Ward – (approved 13.12.2016) - **Discretionary Grant**

2.5 Underspends to be returned to District Committee Revenue Budget 2016-2017

2.6 Underspends to be returned to District Committee Capital Budget 2016-2017

3. Implications for the Council

Implications are as detailed in the attached reports.

4. Consultees and their opinions

Consultees are as detailed in the attached report.

5. Next Steps

Relevant services and organisations and the public will be informed of the committee decisions. If funding is approved projects will be progressed as outlined in the attached reports.

6. Officer recommendations and reasons

As detailed in the attached reports.

7. Cabinet Portfolio holder recommendation

Not applicable

8. Contact Officer and relevant papers

Julie McDowell, Area and Neighbourhood Action Co-ordinator
Communities and Leisure

Tel: 01484 221000

Julie.McDowell@kirklees.gov.uk

Carol Gilchrist, Engagement and Cohesion Manager
Communities and Leisure

Tel: 01484 221000

Carol.gilchrist@kirklees.gov.uk

9. Assistant Director responsible

Kim Brear, Streetscene and Housing

Appendix 1

Report: 1	
Project Name: Developing Golcar Library Garden	
Organisation: Friends of Golcar Library	
Location: Golcar Library	
Ward/ Area: Golcar	
Expected Outcomes: Improvement to outdoor space and increased community use.	
Priorities: Health and Wellbeing; Place	
Amount Requested: (Capital)	£4,188.00
In Kind Match (e.g free use of rooms; equipment)	£0.00
Other Funding (e.g. grants; fundraising; donations):	Up to £1,800.00
Total Cost of Project:	£4,188.53
Number of Volunteers:	
Total Volunteer Hours:	
Number of Beneficiaries:	

Report: 2	
Project Name: Weaving Women's Wisdom	
Organisation: Golcar Together	
Location: Golcar/ Colne Valley Museum	
Ward/Area: Golcar	
Expected Outcomes: Contribution to community cohesion	
Priorities: Health and Wellbeing; Place	
Amount Requested: (Revenue or 10% NHB)	£345.00
In Kind Match (e.g free use of rooms; equipment)	
Other Funding (e.g. grants; fundraising; donations):	£345.00
Total Cost of Project:	£690.00
Number of Volunteers:	12
Total Volunteer Hours:	100
Number of Beneficiaries:	

Report: 3	
Project Name: Car Parking at Cliffe House, Shepley	
Organisation: Kirklees Council	
Location: Cliffe House, Shepley	
Ward/ Area: Kirkburton	
Expected Outcomes: Increase parking capacity and safety of adjacent roads	
Priorities: Place	
Amount Requested: (Revenue or 10% NHB)	£600.00
In Kind Match (e.g free use of rooms; equipment)	£0.00
Other Funding (e.g. grants; fundraising; donations):	£0.00
Total Cost of Project:	£600.00
Number of Volunteers:	
Total Volunteer Hours:	
Number of Beneficiaries:	

Report: 4	
Project Name: Honley Children's Book Festival 2017	
Organisation: Friends of Honley Library	
Location: Honley Library	
Ward/ Area: Holme Valley North	
Expected Outcomes: Improved literacy and community cohesion	
Priorities: Health and Well-being	
Amount Requested: (Revenue or 10% NHB)	£1,000.00
In Kind Match (e.g free use of rooms; equipment)	
Other Funding (e.g. grants; fundraising; donations):	£1,300.00
Total Cost of Project:	£2,300.00
Number of Volunteers:	20 plus
Total Volunteer Hours:	438 min
Number of Beneficiaries:	

Appendix 1

Report: 5
Project Name: Holme Valley Sharing Memories/ Holmfirth Junior and Infant School Project

Organisation: Holme Valley Sharing Memories

Location: Holmfirth Junior and Infant School

Ward/Area: Holme Valley South

Expected Outcomes: Reduce social isolation among older people and young people to learn about heritage and share experiences

Priorities: Health and Well-being

Amount Requested: (Revenue or 10% NHB)	£1,000.00
In Kind Match (e.g free use of rooms; equipment):	£0.00
Other Funding (e.g. grants; fundraising; donations):	£1,138.86
Total Cost of Project:	£2,138.86
Number of Volunteers:	1
Total Volunteer Hours:	12
Number of Beneficiaries:	24

Report 6:
Project Name: Plant It, Grow It, Eat It

Organisation: Communities Who Can

Location: Roundway, Honley

Ward/ Area: Holme Valley North

Expected Outcomes: Creation of fruit and vegetable garden for use by tenants/ residents now and in the future

Priorities: Health and Well-being, Place

Amount Requested: (Revenue or 10% NHB)	£1,500.00
In Kind Match (e.g free use of rooms; equipment):	Yes
Other Funding (e.g. grants; fundraising; donations):	£4,150.00
Total Cost of Project:	£5,650.00
Number of Volunteers:	30
Total Volunteer Hours:	300
Number of Beneficiaries:	130

Report: 7
Project Name: Honley Wood Bridle Path

Organisation: Kirklees Bridleway Group

Location: Honley

Ward/Area: Holme Valley North

Expected Outcomes:

Priorities:

Amount Requested: (Revenue or 10% NHB)	£2,000.00
In Kind Match (e.g free use of rooms; equipment):	£0.00
Other Funding (e.g. grants; fundraising; donations):	£0.00
Total Cost of Project:	£2,000.00
Number of Volunteers:	22
Total Volunteer Hours:	250
Number of Beneficiaries:	

Report: 8
Project Name: Holmbridge Cricket Pavilion

Organisation: Holmbridge Cricket Club

Location: Holmbridge

Ward/Area: Holme Valley South

Expected Outcomes: Completion of works to improve facilities for club/ community use

Priorities: Health and Wellbeing; Place

Amount Requested: (Revenue or 10% NHB)	£3,270.00
In Kind Match (e.g free use of rooms; equipment)	£0.00
Other Funding (e.g. grants; fundraising; donations):	£500.00
Total Cost of Project:	£3,770.00
Number of Volunteers:	22
Total Volunteer Hours:	250
Number of Beneficiaries:	

Report: 9	
Project Name: CAB Provision – Skelmanthorpe Library	
Organisation: Kirklees Citizens Advice and Law Centre	
Location: Skelmanthorpe	
Ward/ Area: Denby Dale	
Expected Outcomes: Individuals incomes maximised	
Priorities: Social action; supporting people to take action for themselves	
Amount Requested: (Revenue or 10% NHB)	£4,475.00
In Kind Match (e.g free use of rooms; equipment):	£0.00
Other Funding (e.g. grants; fundraising; donations):	£0.00
Total Cost of Project:	£4,475.00
Number of Volunteers:	
Total Volunteer Hours:	
Number of Beneficiaries:	

Report: 10	
Project Name: Improvements to the Kirkburton Spur of the Trans Pennine Trail	
Organisation: Denby Dale Walkers are Welcome	
Location: Long Lane, Thunderbridge and Bank Lane, Denby Dale	
Ward/Area: Denby Dale/ Kirkburton	
Expected Outcomes: Improved surfaces and increased use of the link	
Priorities: Health and Wellbeing; Place	
Amount Requested: (Revenue or 10% NHB)	£8,252.00
In Kind Match (e.g free use of rooms; equipment):	£0.00
Other Funding (e.g. grants; fundraising; donations):	£33,004.00
Total Cost of Project:	£41,256.00
Number of Volunteers:	
Total Volunteer Hours:	
Number of Beneficiaries:	

Report: 11	
Project Name: Slaithwaite Civic Hall	
Organisation: Slaithwaite Civic Hall Trust	
Location: Slaithwaite	
Ward/ Area: Colne Valley	
Expected Outcomes: Reliable heating system, warm venue available to hire	
Priorities: Communities looking after local assets for all to use and enjoy	
Amount Requested: (Revenue or 10% NHB)	£12,000.00
In Kind Match (e.g free use of rooms; equipment):	£0.00
Other Funding (e.g. grants; fundraising; donations):	£8,400.00
Total Cost of Project:	£20,400.00
Number of Volunteers:	Oct - 20
Total Volunteer Hours:	60
Number of Beneficiaries:	

Report: 12	
Project Name: Road widening St Mary's Mews, Honley	
Organisation: Kirklees Highways	
Location: St Mary's Mews, Honley	
Ward/Area: Holme Valley North	
Expected Outcomes: Road widened and improved safety	
Priorities: Place	
Amount Requested: (Revenue or 10% NHB)	£7,500.00
In Kind Match (e.g free use of rooms; equipment):	£0.00
Other Funding (e.g. grants; fundraising; donations):	£0.00
Total Cost of Project:	£7,500.00
Number of Volunteers:	
Total Volunteer Hours:	
Number of Beneficiaries:	

Report: 13	
Project Name: Litherup Lane, Clayton West - Littering	
Organisation: Kirklees Highways	
Location: Litherup Lane, Clayton West	
Ward/Area: Denby Dale	
Expected Outcomes: Prevention of littering	
Priorities: Place	
Amount Requested: (Revenue or 10% NHB)	£600.00
In Kind Match (e.g free use of rooms; equipment):	Donated boulders
Other Funding (e.g. grants; fundraising; donations):	£0.00
Total Cost of Project:	£600.00
Number of Volunteers:	
Total Volunteer Hours:	
Number of Beneficiaries:	

Report: 14	
Project Name: Mental Health First Aid Training	
Organisation:	
Location: Kirklees Rural District	
Ward/Area: All Kirklees Rural	
Expected Outcomes: Community champions able to recognise and respond/ aware of local provision to support those at risk	
Priorities: Health and Wellbeing	
Amount Requested: (NHB)	£14,000.00
In Kind Match (e.g free use of rooms; equipment):	£0.00
Other Funding (e.g. grants; fundraising; donations):	0.00
Total Cost of Project:	£14,000.00
Number of Volunteers:	
Total Volunteer Hours:	
Number of Beneficiaries:	

Report: 15	
Project Name: Community physical activity programme	
Organisation: Sport and Physical Activity Team	
Location: Kirklees Rural	
Ward/Area: All Kirklees Rural	
Expected Outcomes: Children and adults leading a sedentary lifestyle supported to participate in physical activity	
Priorities: Health and Wellbeing	
Amount Requested: (NHB)	£15,000.00
In Kind Match (e.g free use of rooms; equipment):	£0.00
Other Funding (e.g. grants; fundraising; donations):	£0.00
Total Cost of Project:	£15,000.00
Number of Volunteers:	
Total Volunteer Hours:	
Number of Beneficiaries:	

Report: 16	
Project Name: Marsden Skatepark	
Organisation: Streetscene and Housing	
Location: Marsden	
Ward/Area: Colne Valley	
Expected Outcomes: New facility for young people and families	
Priorities: Access to physical activities in local communities	
Amount Requested: (NHB)	£25,000.00
In Kind Match (e.g free use of rooms; equipment):	£0.00
Other Funding (e.g. grants; fundraising; donations):	£55,000.00
Total Cost of Project:	£80,000.00
Number of Volunteers:	
Total Volunteer Hours:	
Number of Beneficiaries:	

Report: 17	
Project Name: Denby Dale to Upper Cumberworth Path	
Organisation: Kirklees Public Rights of Way	
Location: Denby Dale/ Upper Cumberworth	
Ward/Area: Denby Dale	
Expected Outcomes: Improved path surface for walkers	
Priorities: Health and Wellbeing/ Place	
Amount Requested: (NHB)	£27,000.00
In Kind Match (e.g free use of rooms; equipment):	£0.00
Other Funding (e.g. grants; fundraising; donations):	£0.00
Total Cost of Project:	£27,000.00
Number of Volunteers:	
Total Volunteer Hours:	
Number of Beneficiaries:	

Report: 18	
Project Name: Loan request regarding grant application to EPIP	
Organisation: Denby Dale Walkers are Welcome	
Location: Denby Dale/ Kirkburton	
Ward/Area: Denby Dale/ Kirkburton	
Expected Outcomes: Facilitated cash flow	
Priorities: Communities looking after local assets for all to use and enjoy	
Amount Requested: (NHB)	£33,244.00
In Kind Match (e.g free use of rooms; equipment):	£0.00
Other Funding (e.g. grants; fundraising; donations):	£0.00
Total Cost of Project:	£33,244.00
Number of Volunteers:	
Total Volunteer Hours:	
Number of Beneficiaries:	

Report: 19	
Project Name: Colne Valley Bridleway No. 197	
Organisation: Kirklees Public Rights of Way	
Location: Marsden	
Ward/Area: Colne Valley	
Expected Outcomes: Improved path surface for users	
Priorities: Health and Wellbeing/ Place	
Amount Requested: (NHB)	£22,500.00
In Kind Match (e.g free use of rooms; equipment):	£0.00
Other Funding (e.g. grants; fundraising; donations):	Match to be sought
Total Cost of Project:	£22,500.00
Number of Volunteers:	National Trust
Total Volunteer Hours:	
Number of Beneficiaries:	

Report: 20	
Project Name: Speed limit reduction orders Denby Dale/ Kirkburton	
Organisation: Kirklees Highways	
Location: A629 and B6116	
Ward/Area: Denby Dale/ Kirkburton	
Expected Outcomes: Improved safety for road users/ residents	
Priorities: Place	
Amount Requested: (NHB)	£52,000.00
In Kind Match (e.g free use of rooms; equipment):	£0.00
Other Funding (e.g. grants; fundraising; donations):	£0.00
Total Cost of Project:	£52,000.00
Number of Volunteers:	
Total Volunteer Hours:	
Number of Beneficiaries:	



Name of meeting: District Committee – Kirklees Rural Public Meeting

Date: 25th February 2017

Title of report: Golcar Library Garden

Is it likely to result in spending or saving £250k or more, or to have a significant effect on two or more electoral wards?	Not applicable
Is it in the Council's Forward Plan?	Not applicable
Is it eligible for call in by Scrutiny?	Yes
Date signed off by <u>Director</u> & name	Kim Brear, Assistant Director Streetscene & Housing 13/02/17
Is it signed off by the Director of Resources?	No financial implications
Is it signed off by the Assistant Director – Legal, Governance & Monitoring?	No legal implications
Cabinet member portfolio	Not applicable

Electoral [wards](#) affected: Golcar

Ward councillors consulted: Councillors Andrew Marchington, Christine Iredale and Hilary Richards

Public or private: Public

1. Purpose of report

The Committee is asked to consider a contribution of £4,188.53 capital towards the refurbishment of the Golcar library garden.

2. Key points

2.0 The Friends of Golcar Library plan to refurbish the garden, path and patio area to create disabled access and to replace the worn and uneven patio with a disabled friendly surface. The space is approximately 500m².

2.1 The garden will be used for activities linked directly to Golcar Library such as story time, picnics, family activities (The Big Lunch) and initiatives to combat social isolation among the elderly. It will also be available for formal and informal groups in the wider community to use.

2.2 Currently 1,350 people per month use Golcar Library and it is anticipated that this development will increase that number. The project will enhance the environment and provision of greenspace in the local community and help groups to be more socially inclusive.

2.3 The work will be done by Kirklees Council Parks, Open Spaces and Street Cleaning Development Team. The quote provided by the team is:

- To do the top area of the garden, remove slabs and stack up, lay rubber crumb surfacing in black £ 2,418.58
- Ramp construction and new curving pathway to gated entrance with timber edges and crush stone surface 1.2 metre wide £ 3,270.00
- **Total £5688.58**

2.4 Cost Breakdown

Item	Amount requested from District Committee	Amount funded from other sources	Total Cost
Remove existing patio & relay with rubber crush surface	£1,918.53	£500	£2,418.58
Ramp & curved pathway construction	£2,270	£1,000	£3,270
Total	£4,188.53	£1,500	£5,688.58

A grant of up to £1,800 has been secured by the Friends of Golcar Library from the Co-operative Retail Society towards the project. The actual amount will be known when this round for community projects closes.

2.5 Timescale

It is expected that the work will start in April 2017 and take 4 weeks to complete.

2.6 Volunteers

The hard landscaping would all be done by the Council team. There would be scope for volunteers to add to the project in the building and planting raised beds etcetera but this would be seen as a future phase of the project. The initial funding would be for the hard landscaping of the patio area, ramp access and path down the garden area.

3. Implications for the Council

The approval for the work on the Library site comes from Robert Crossland, Asset Management Officer, Place (Physical Resources & Procurement)-

In principle we don't have any objections to what is being proposed, however please bear in mind:

- The land remains in the Council's ownership and under the control of Physical Resources and Procurement.
- The group undertaking the work is responsible for all aspects of Health and Safety and for management of the scheme.
- Any "investment" by the group does not give any additional rights above current arrangements.
- If there is a review in the future the group may lose its investment.
- Access to the vacant first floor flat will need to be maintained.

The application meets the district committee criteria of Place; communities looking after local assets for all to use and enjoy and Health and wellbeing.

4. Consultees and their opinions

Kirklees Library Service is supportive of the proposal.

Andy Wickham, Volunteer Co-ordinator Streetscene and Housing is supportive.

Golcar Ward Councillors are supportive of the proposal.

5. Next steps

If funding is approved the Friends of Golcar Library will be asked to give feedback on the project.

6. Officer recommendations and reasons

The Committee is asked to consider allocating £4,188.53 capital towards the project.

7. Cabinet portfolio holder's recommendations

Not applicable

8. Contact officer and relevant papers

Julie McDowell, Area & Neighbourhood Co-ordinator, Tel 01484 221000
email: julie.mcdowell@kirklees.gov.uk

9. Assistant director responsible

Kim Brear, Streetscene and Housing

Name of meeting: District Committee - Kirklees Rural Public Meeting

Date: 25th February 2017

Title of report: Grant application – Weaving Women’s Wisdom

Is it likely to result in spending or saving £250k or more, or to have a significant effect on two or more electoral wards?	Not applicable
Is it in the Council’s Forward Plan?	Not applicable
Is it eligible for call in by Scrutiny?	Yes
Date signed off by <u>Director</u> & name	Kim Brear, Assistant Director Streetscene and Housing, 13/02/17
Is it signed off by the Director of Resources?	No financial implications
Is it signed off by the Assistant Director – Legal, Governance & Monitoring?	No legal implications
Cabinet member portfolio	Not applicable

Electoral [wards](#) affected: Golcar

Ward councillors consulted: Councillors Christine Iredale, Andrew Marchington and Hilary Richards

Public or private: Public

1. Purpose of report

To consider a grant application by Golcar Together for £345.50 revenue contribution towards the Weaving Women’s Wisdom project.

2. Key points

2.0 Golcar Together has brought together a group of women of different faiths and no faith to weave small rugs together which illustrate a picture of their joint vision. This follows an idea launched by the Touchstone Interfaith project in Bradford and taken up across the country.

- 2.1** The 450 x 900 mm rugs will be made using the shared skills of the rug makers. The expectation is that the women will share their life experiences and their faith over the duration of the project which will last about 6 months. The voices of the women will be digitally recorded and will be given to the Kirklees Library Service and to the Colne Valley Museum as part of their record of local history.
- 2.2** The project will be based at the Colne Valley Museum in Golcar with a core group of around 12 local women who will undertake production of the rugs. The project aim is to build local friendships across ethnic and religious divides and it will promote community cohesion. Many of the core group will live in Golcar Ward, others will come from the wider Huddersfield area.
- 2.3** Golcar Together has approached representatives of the major religions in the area to let them know about the project and ask them if they have any interested participants. They have also approached other local non-religious organisations to ask the same question. The invitation process is ongoing. Ten volunteers have come forward so far. The facilitators Touchstone believe from their experience that the optimum number is 8 for a single rug. If 12 women are interested then the suggestion is that they make 2 rugs. Examples of rugs made from other areas –





2.4 Cost breakdown

Item	Amount requested from District Committee	Amount requested from other sources	Total Cost
Portable recorder	£40.50	£40.50	£81
Hessian canvas	£12.50	£12.50	£25
Wool for weaving	£50	£50	£100
Needles/ ancillary items	£15	£15	£30
Plastic storage boxes x3	£14.50	£14.50	£27
Touchstone facilitation	£125	£125	£250
Public liability insurance	£38	£38	£76
Cost of exhibition	£50	£50	£100
Total	£345.50	£345.50	£691

An application for £345.50 has been made to the By and Buy Community Shop in Golcar for 50% of the cost. The decision on funding will be made on 13th March 2017.

The digital recorder will be lodged with Colne Valley Museum for their safekeeping at the end of the project. The museum will use it for memory recording and it will be available to groups on request.

The grant application has been put together on the basis that all the items are bought new. It is likely that the wool and/or rags can be sourced locally at no expense. It may be that the needles, ancillaries and hessian canvass can also be obtained from participants.

2.5 Volunteers

Touchstone believe that the number of volunteer-hours for a single 450x900mm rug is likely to be around 100 hours.

2.6 Timescale

The project will take place from April to October 2017.

3. Implications for the Council

The group's Grant Access Point registration with the Council is currently being renewed. If the grant is approved the group will enter into a grant agreement with the Council.

The application meets the district committee priorities of Place, communities looking after local assets for all to use and enjoy.

4. Consultees and their opinions

Colne Valley Museum has welcomed this project and believes that it forms an important part of its outreach to the wider community as well as being a valuable addition to its collection of local history. The museum has agreed to host an exhibition of rugs from across Yorkshire in January 2018.

Golcar Ward Councillors are supportive. Cllr Hilary Richards is a member of the Group. "I am happy to support this request as another small step in bringing communities together."

5. Next steps

If the grant application is approved the group will be asked to give feedback on the project.

6. Officer recommendations and reasons

The Committee is asked to consider the application with any funding approved subject to renewal of the GAP registration.

7. Cabinet portfolio holder's recommendations

Not applicable

8. Contact officer and relevant papers

Julie McDowell, Area and Neighbourhood Co-ordinator,
Tel 01484 221000 email: julie.mcdowell@kirklees.gov.uk

9. Assistant director responsible

Kim Brear, Streetscene and Housing



Name of meeting: District Committee – Kirklees Rural Public Meeting

Date: 25th February 2017

Title of report: Car Parking at Cliffe House, Shepley

Is it likely to result in spending or saving £250k or more, or to have a significant effect on two or more electoral wards?	Not applicable
Is it in the Council's Forward Plan?	Not applicable
Is it eligible for call in by Scrutiny?	Yes
Date signed off by <u>Director</u> & name	Kim Brear, Assistant Director Streetscene & Housing 13/02/17
Is it signed off by the Director of Resources?	No financial implications
Is it signed off by the Assistant Director – Legal, Governance & Monitoring?	No legal implications
Cabinet member portfolio	Not applicable

Electoral [wards](#) affected: Kirkburton

Ward councillors consulted: Bill Armer, John Taylor, Richard Smith

Public or private: Public

1. Purpose of report

To consider £600 revenue funding for the redesign of the car park at Cliffe House, Shepley in order to increase its capacity and the safety of adjacent roads.

2. Key points

Background

2.0 Councillor John Taylor is working with staff at Cliffe House to resolve a parking problem which is causing some road safety concerns on Cliffe Road and Lane Head Road, Shepley. Since some additional services have been moved into Cliffe House and the usage has increased the car park has proved inadequate.

As a result cars are parked on the narrow road outside and also more dangerously on the main A629 just adjacent to the entrance to Cliffe Road.

This is also causing some problems with schoolchildren accessing the site as they often arrive by coach. There have been instances when the coach is stuck as it cannot access the site because of the car parking outside of Cliffe House.

2.1 It is proposed that the car park be redesigned to increase capacity. Kirklees Highways has recommended local company Alpha Marking Services Ltd undertake the work.

2.2 A quote for £600 (excluding VAT) has been provided to reconfigure the car park. This should provide an additional 10 spaces, an increase from 22 to 32. *A sketch of the existing and the proposed layout is attached at appendix 1.* 30 spaces are set out on the plan with another 2 to be included.

3. Implications for the Council

The proposal meets the district committee's priority of Place and Streetscene issues, local assets being looked after for all to use and enjoy.

4. Consultees and their opinions

Kirklees Highways Service is supportive.

Kirklees Corporate Landlord has been consulted on the proposal and has no objection.

Kirklees Learning Service is responsible for Cliffe House. The proposal has been developed with the Business Development/ Project Manager at Cliffe House.

Kirkburton Ward Councillors are supportive of the proposal.

5. Next steps

The work will take place as soon as funding is in place.

6. Officer recommendations and reasons

The Committee is asked to consider the funding proposal.

7. Cabinet portfolio holder's recommendations - Not applicable

8. Contact officer and relevant papers

Julie McDowell, Area and Neighbourhood Co-ordinator,
Area and Neighbourhood Team, Tel 01484 221000
email: julie.mcdowell@kirklees.gov.uk

9. Assistant director responsible

Kim Brear, Streetscene and Housing

EXISTING LAY OUT

CLIFFE HOUSE CAR PARK

3" Lines,
ALL VISIBLE, used
Rough 15H SURFACE.

3 new Parallel Bays Between
1 way sign and Proposed new gate Post

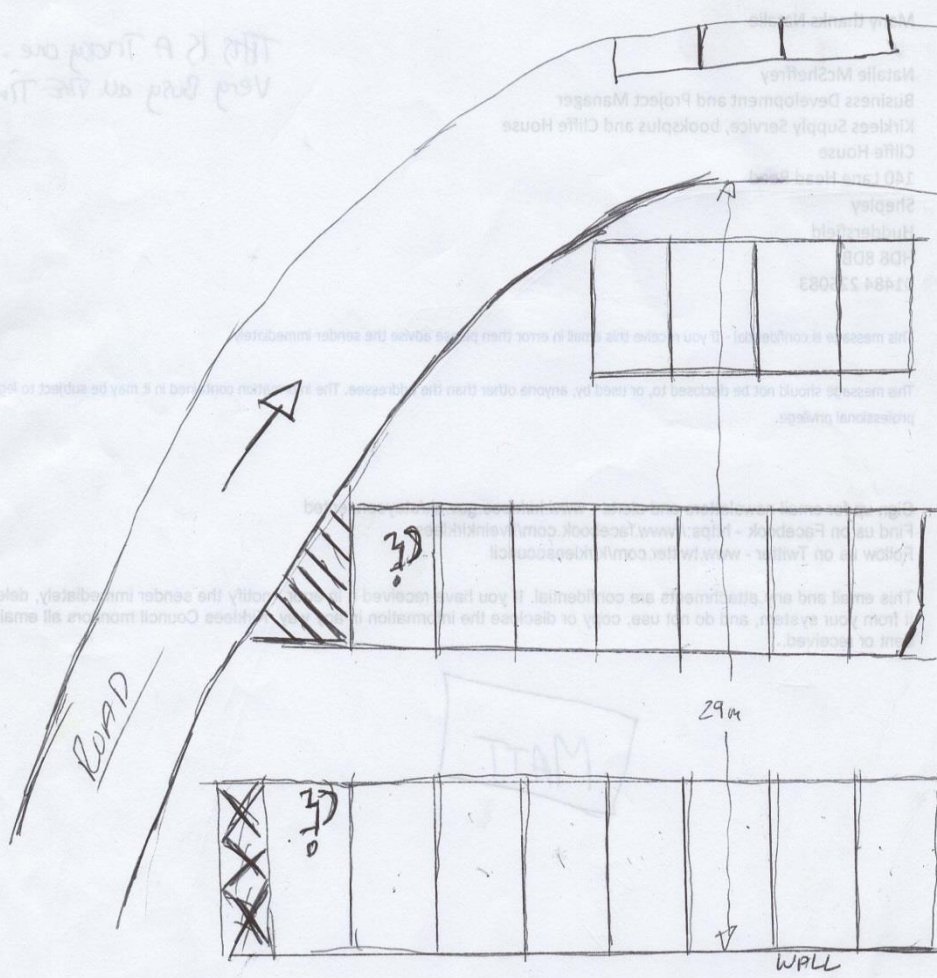

HAVE BAYS APPROX 4-5m
AND GAPS 5-5m.

KEEP SAME ORIENTATION.
SQUEEZE ANOTHER MIDDLE BLOCK OF BAYS IN.

POSSIBLE PROPOSED LAY OUT.
CLIFFE HOUSE CAR PARK

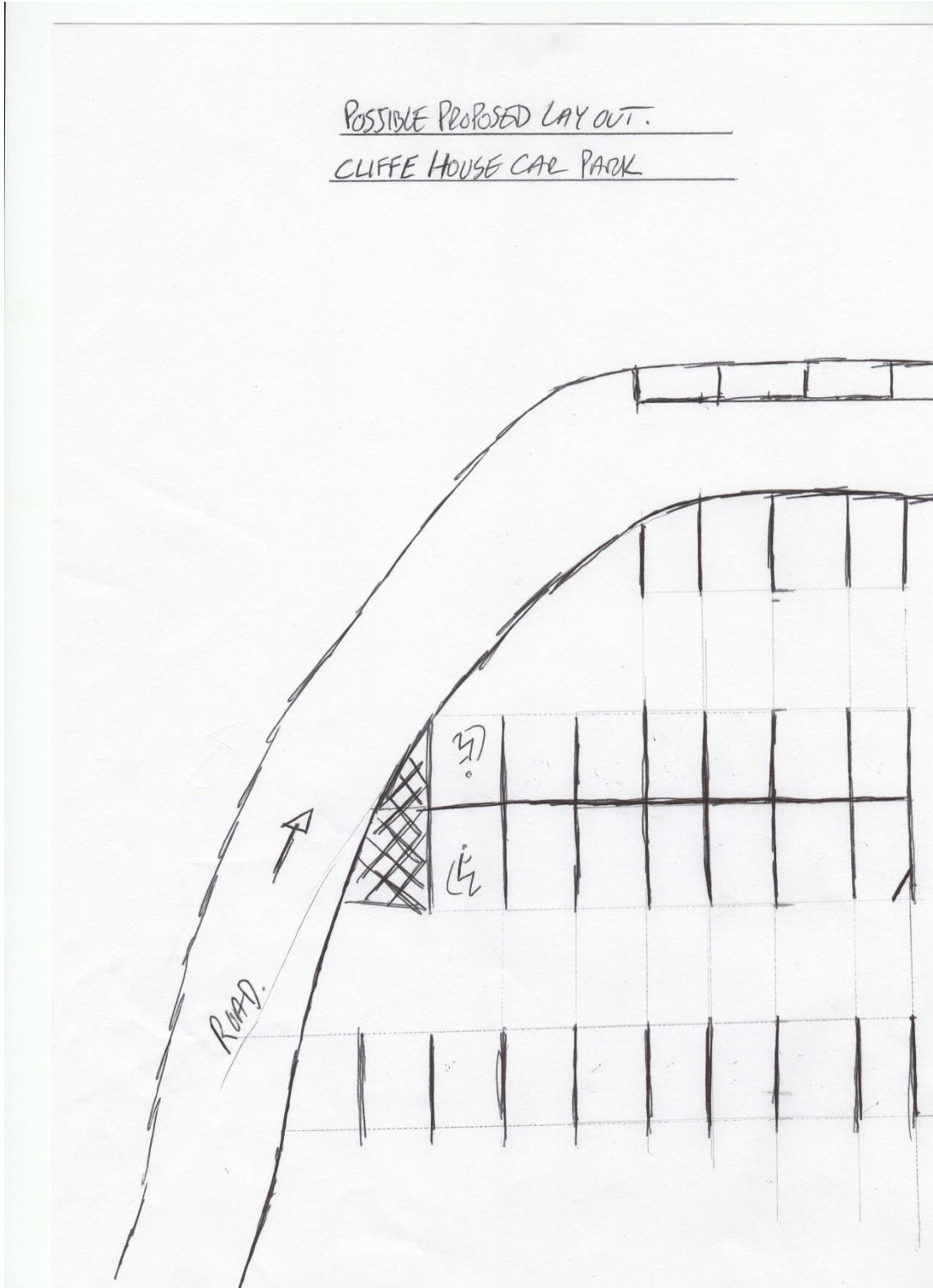



Name of meeting: District Committee – Kirklees Rural Public Meeting

Date: 25th February 2017

Title of report: Grant application – Honley Children’s Book Festival 2017

Is it likely to result in spending or saving £250k or more, or to have a significant effect on two or more electoral wards?	Not applicable
Is it in the Council’s Forward Plan?	Not applicable
Is it eligible for call in by Scrutiny?	Yes
Date signed off by <u>Director</u> & name	Kim Brear, Assistant Director Streetscene & Housing, 13/02/17
Is it signed off by the Director of Resources?	No financial implications
Is it signed off by the Assistant Director – Legal, Governance & Monitoring?	No legal implications
Cabinet member portfolio	Not applicable

Electoral [wards](#) affected: Holme Valley North

Ward councillors consulted: Councillors Charles Greaves, Edgar Holroyd Doveton, Terry Lyons

Public or private: Public

1. Purpose of report

The Committee is asked to consider a grant application by the Friends of Honley Library for £1,000 towards the Honley Children’s Book Festival 2017.

2. Key points

2.0 The Friends of Honley Library runs activities during the school holidays for children from birth, focussing on children and families who do not use the library. The programme provides opportunities for literacy and enjoyment of books through affordable, enjoyable activities in the library.

- 2.1** Last year's festival included puppet making, "Shark in the Park", Babies into Books, craft workshops, Little Elves, Story Sacks, and author visits (creative writing and a poetry workshop). *The proposed programme for 2017, from February half term through to Christmas, is attached.* Most of the events will take place at Honley Library, some will be outdoors at Honley Woods and the People's Park.
- 2.2** Last year's summer book festival was popular, 112 adults and 156 children benefited and were mostly Honley residents. A summary of the evaluation is attached. The programme has an established reputation and the good will of the local community. The group works with local schools and playgroups to recruit participants. It is anticipated that an extended programme in 2017 will increase the number of participants to around 300 adults and 300 children. High school age young people and children with special needs will be included this year.
- 2.3** Monitoring information on the impact of the programme is collected including new library members. For example increased use of the library especially by families for which schools receive the pupil premium, increased confidence of the children and difference it makes on their achievement at school. The programme aims to use local businesses wherever possible. It has resulted in more people volunteering at the library.

2.4 Cost Breakdown

Item	Amount requested from District Committee	Amount funded from other sources	Total Cost
Resources (craft materials, paper, card, pens, fabric, sensory materials)	-	480	480
Publicity (leaflets, fliers, photos, posters)	-	370	370
Professional led workshops, author visits, bands, art groups, environmental group	1,000	420	1420
Volunteer expenses	-	30	30
Total	£1,000	£1,300	£2,300

The Group is contributing £300 from its own funds, and is making an application to Holme Valley Parish Council for £1,000.

There is a small charge of 50p per child for each event.

2.5 Timescale

The programme starts at February half term and runs during the school holidays until 31st December 2017. The cost of the February half term activities of £50 is to be met by the Group.

2.6 Volunteers

A strong group of Friends and volunteers works to sustain the library facility, supporting the local community and increasing social capital. A minimum of 20 volunteers will contribute at least 438 hours in total. They will be planning, marketing, sourcing resources, delivering events, booking artists and authors, fundraising, evaluating, photographing and displaying work in the library.

3. Implications for the Council

The Friends of Honley Library is registered with the Council's Grant Access Point. If the grant is approved the group will enter into a grant agreement with the Council.

The application meets the district committee priorities of Place; communities looking after local assets for all to use and enjoy and Health and wellbeing.

Permission has been given by Kirklees Library Service for the events to take place outside of library opening times. Library Service insurance will cover the the activities planned.

4. Consultees and their opinions

Kirklees Library Service "last year's festival was a great success, drew new people into the library and gave the volunteers opportunities to engage with the people of Honley. This grant, together with the learning they will have taken from last year's event, will give them an opportunity to expand their offer."

Ward Councillors are supportive.

5. Next steps

If the grant is approved the group will be asked to give feedback on the project.

6. Officer recommendations and reasons

The Committee is asked to consider the application.

7. Cabinet portfolio holder's recommendations

Not applicable

8. Contact officer and relevant papers

Julie McDowell, Area & Neighbourhood Co-ordinator, Tel 01484 221000
email: julie.mcdowell@kirklees.gov.uk

9. Assistant director responsible

Kim Brear, Streetscene and Housing

Attached – proposed programme
2016 evaluation and photos

Appendix

Honley Children's Book Festival

OUTGOINGS: Total £2300

Author visits and groups £1420

Resources £410

volunteer expenses and travel £100

total publicity, promotion and printing £370

INCOME FROM any donations and CHARGES FOR EVENTS @0.50 per child
TOTAL £150.00

average volunteer hours per event is 30 hours if the event is entirely run by
volunteers.

average volunteer hours per event is 22 hours if the event is led by author or
professional group.

Summary of programme and expenditure for Honley Children's Festival 2017
All events are held in school holidays - still at the planning stage
(vh = volunteer hours)

WHEN will it take place?	Workshops dependent on authors or professional groups	Cost £	Workshops delivered by volunteers only	Cost resources £	Total £ per workshop
February	<i>No paid group or author</i>		<i>Mardi Gras workshop (1) music, craft, games, story (vh=30)</i>	50	50
Easter	<i>Group workshop (1) will take place in Honley woods Led by local group Fair & Funky</i>	200	<i>volunteers support (vh=22)</i>		200
			<i>Workshop (2) in Honley woods with den building, minibeasts, leaf pressing, stories (vh=30)</i>	50	50
Spring bank half-term	<i>Author workshop (2) Alan Gibbons - Y6 pupils transition to high school</i>	200	<i>volunteers support (vh=22)</i>	20	220
			<i>preparation for summer - workshop (3) Pirate workshop (vh=30)</i>	60	60

Summer	<i>Pirate workshop (3) led by author Chris Mould</i>	150	<i>volunteers support (vh=22)</i>	20	170
	<i>2. Creative workshops (4 and 5) art and music – led by Manasamitra for younger children a.m. and p.m. for High School pupils</i>	250	<i>volunteers support (vh=44)</i>	20	270
	<i>3. Two creative art, music, workshops (6 and 7) run in Honley Library by local group Children’s Art School</i>	120	<i>volunteers support (vh=44)</i>	40	120
	<i>4. Author visit (8): creative writing for high school children</i>	350	<i>Volunteer - led workshops:-</i>	30	380
			<i>(4) Special needs workshop (vh=30)</i>	50	50
			<i>(5) People’s Park story, music, games and movement activity with resources and volunteer expenses (vh=30)</i>	50	50
		<i>(6) Babies into Books – resources with library book packs (vh=30)</i>	<i>baby book bags</i>	30	

October	<i>Poetry for under 8's workshop (9) led by author Conrad Burdekin</i>	150	<i>volunteer support (vh=22)</i>	50	200
			<i>Volunteers with Honley Library and partners Honley Business Association lead workshop (7) for children to make display for Xmas lights (vh=30)</i>	60	60
Xmas			<i>Xmas craft, music, story workshop (8) led by volunteers (vh=30)</i>	50	50
Publicity for summer	<i>Posters and leaflets PCV banner</i>	170			170
Publicity for other events in programme	<i>Fliers and PVC banners</i>	100			100
printing and laminating	<i>print and laminate photos and children's work</i>	100			100

Key Points from Evaluation of Honley Children's Summer Book Festival 2016

Evaluation forms were distributed and collected at last year's book festival events.

Participants are asked to answer seven questions. We ask for information about how the children enjoyed the event, rated on a scale of 0-5 with 5 being very much and 0 being not at all. We also asked about frequency of visits to the library; whether it was a first time visit; and whether attending the event encouraged more frequent visits to the library. The last questions ask what future events participants would like to see, and ask if anyone would like to volunteer or offer support of the library in other ways.

The events run in 2016 were attended by a total of 156 children and 112 adults:

- **'Shark in the Park'** - an interactive story-telling event attended by 38 children and 26 adults.
- in Honley People's Park, with treasure hunt and games

- **Babies into Books** - encouraging parental confidence in introducing books to babies. 27 adults and 25 children attended. It was the first visit to the library for five people and nine people joined the library as new members.
- **Puppet-making** attended by 9 adults and 17 children
- **Story sacks** attended by nine adults and 16 children
- **Author visit with Alan Gibbons** for 8-11s : an interactive workshop on creative writing attended by 11 adults and 19 children
- **Author visit with Conrad Burdekin** - poetry workshop in October 2016 for 4-8 year olds. This was attended by 11 adults and 17 children
- **Little Elves workshop** (pre-Christmas event) - attended by 24 children and 19 adults
- None of these events interrupted normal running of the library. Funds to run the events were raised through a sponsored swim, and two grants from Friends of Honley Library and Honley Village Trust. Author visits were especially enjoyed as the authors were experienced in engaging the children.

What we learned:

- Last year's events were attended by 112 adults and 156 children.
- Overall reactions showed that 28 to of 33 evaluations gave score of 5 for enjoyment of the events.
- The remaining 5 evaluations rated the events as 4. Out of possible score of 165 we achieved 156 (95%)
- On average, about 25% of those attending each event said the event had encouraged them to visit the library more often. At all the events held in the library there were participants for whom this was their first visit
- The workshops were very effective in signing up new library members (especially Babies into Books where new members included nine babies, one parent and a pensioner)
- Marketing is a job in itself!
- We have a great team of volunteers who give time to these activities, including childcare and adult learning professionals. Some volunteers have taken part in library services training which will allow us to offer story workshop events for children with special needs. We also plan to offer more for high-school aged pupils.

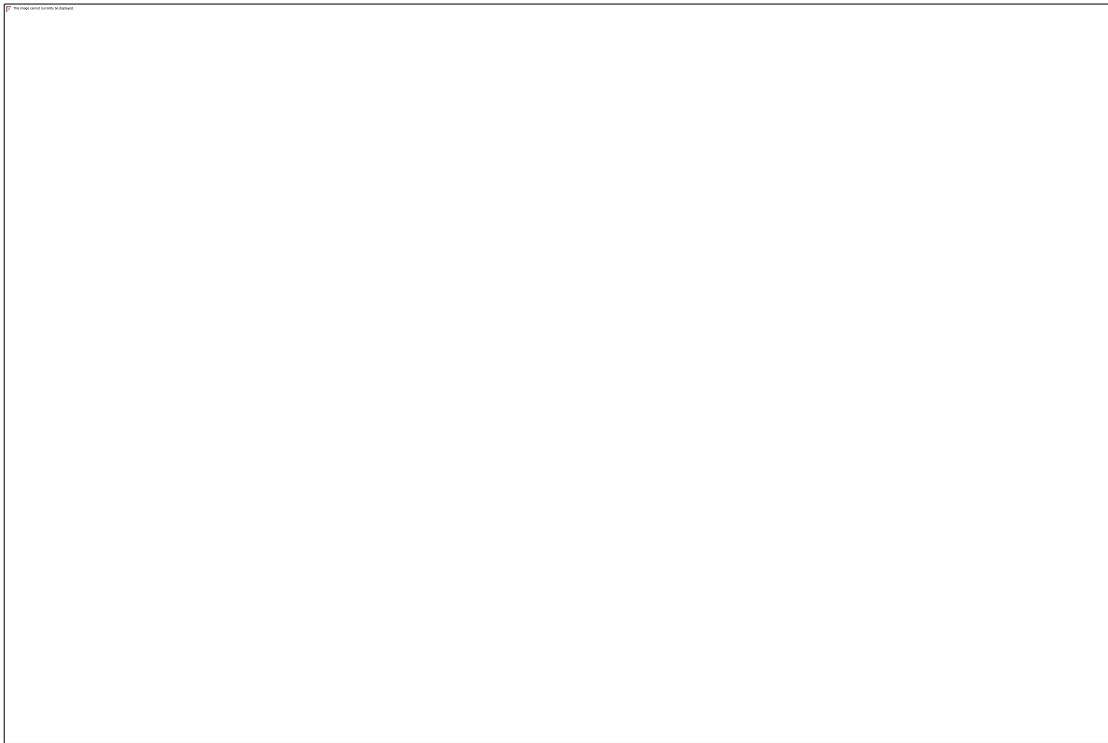
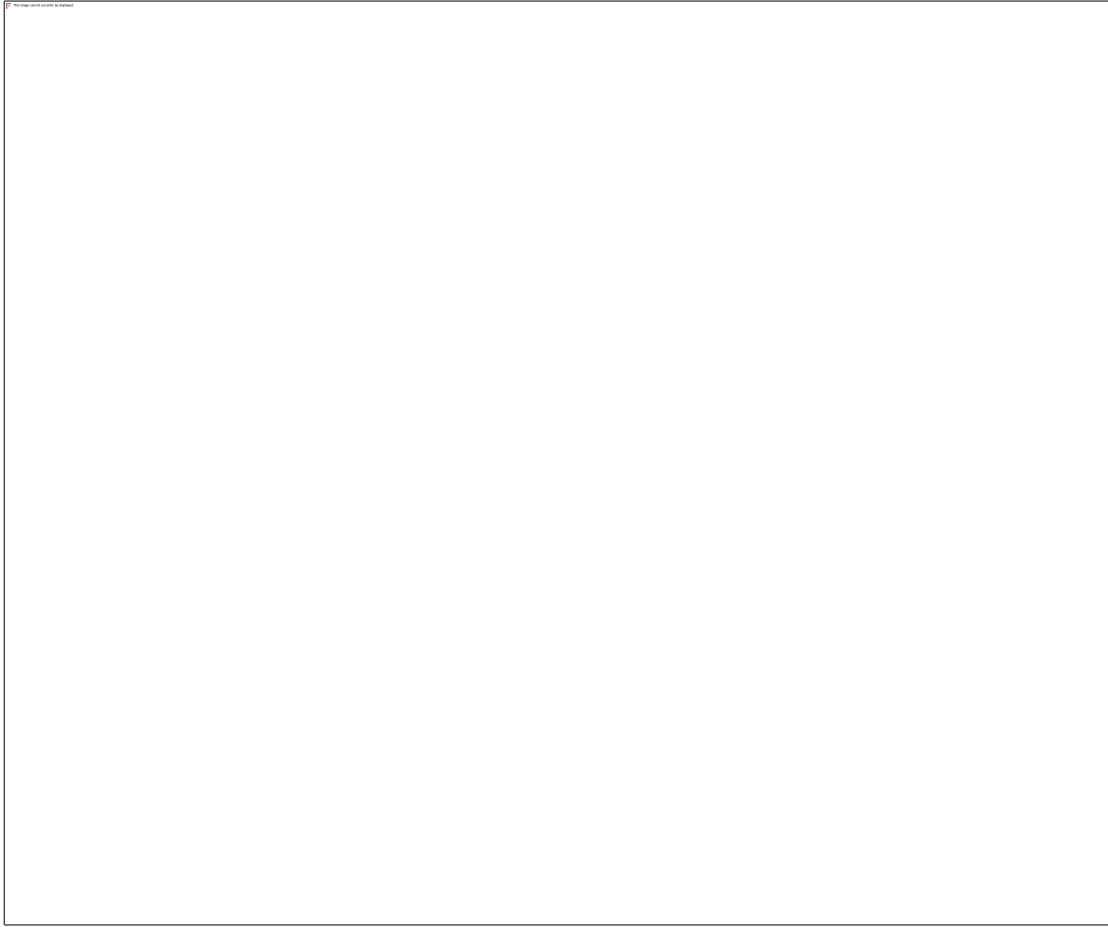



Name of meeting: District Committee - Kirklees Rural Public Meeting

Date: 25th February 2017

Title of report: Grant application – Holme Valley Sharing Memories and Holmfirth Junior and Infant School project

Is it likely to result in spending or saving £250k or more, or to have a significant effect on two or more electoral wards?	Not applicable
Is it in the Council's Forward Plan?	Not applicable
Is it eligible for call in by Scrutiny?	Yes
Date signed off by <u>Director</u> & name	Kim Brear, Assistant Director Streetscene & Housing 13/02/17
Is it signed off by the Director of Resources?	No financial implications
Is it signed off by the Assistant Director – Legal, Governance & Monitoring?	No legal implications
Cabinet member portfolio	Not applicable

Electoral [wards](#) affected: Holme Valley South

Ward councillors consulted: Councillors Donald Firth, Nigel Patrick and Ken Sims

Public or private: Public

1. Purpose of report

To consider a grant application by Holme Valley Sharing Memories Group for £1,000 revenue contribution to an intergenerational project with a group of pupils at Holmfirth Junior and Infant School in Spring 2017.

2. Key points

2.0 Members of the Holme Valley Sharing Memories Group (all older people in their 70's, 80's and 90's) will work with a group of pupils to learn a favourite song, talk about their local identity and get to know each other better. At the end

of the project they will share their songs with a wider audience at a public performance in Huddersfield. They will discuss where they live and how they live together, and express their identity through the personal songs and artwork as part of the larger event.

- 2.1** This project brings together two diverse groups; ten elderly members of the Group and 14 Key Stage 2 pupils, age 7 to 11 years. Members of the Holme Valley Sharing Memories Group experience a high degree of social isolation due to the fact that they live alone or care for someone with mental/ physical needs. The project gives them the opportunity to work with young people which boosts their confidence and sense of self worth, and makes them feel valued as members of their community.
- 2.2** Young people will get the opportunity to have meaningful conversations with older people from their community, find out more about local heritage and share life experiences in a creative way. They will have opportunity to share what they have learnt on a public platform in front of a much larger audience.
- 2.3** The project will also create opportunities for future partnership working locally.

2.4 Cost breakdown

Item	Amount funded from District Committee	Amount funded from other sources	Total Cost
Sharing Memories core artist fees: 2 artists x 5 weeks at £110 per week is £1,100	£500	£600	£1,100
Sharing Memories project manager fees: 1 project manager x 5 weeks at £110 per week is £550	£250	£300	£550
Taxis to transport members of Sharing Memories to school: 5 weeks x £75 is £375	£250	£125	£375
Public liability insurance: 2 months at £31.93 is £63.86	-	£63.86	£63.86
Materials for artwork (banners, flags, ribbons for final performance)	-	£50	£50
Total	£1,000	£1,138.86	£2,138.86

Holmfirth Junior and Infant School will be contributing £250 towards the project and £888.86 will be contributed from the Group.

2.5 Timescale

The project will start on 9th March 2017 and last 4 weeks with a shared performance day in Summer.

2.6 Volunteers

One volunteer will support the older people to work with the young people, ensuring people feel safe and understand what is going on within the project, 12 hours in total.

3. Implications for the Council

The application meets the district committee's priority of health and well being; communities looking after each other.

The Group is registered with the Council's Grant Access Point and has a high standard of governance and management, with appropriate policies and procedures in place. If the grant is approved the group will enter into a grant agreement with the Council.

4. Consultees and their opinions

Planning meetings have taken place with Holmfirth School to discuss the objectives and outcomes of the project. The school has made parents aware that pupils will be working with the Group.

Ward Councillors are supportive of the project.

5. Next steps

Subject to approval of the grant the funding will be paid to the group and feedback will be provided.

6. Officer recommendations and reasons

The Committee is asked to consider the application.

7. Cabinet portfolio holder's recommendations

Not applicable

8. Contact officer and relevant papers

Julie McDowell, Area & Neighbourhood Co-ordinator,
Tel 01484 221000
email julie.mcdowell@kirklees.gov.uk

9. Assistant director responsible

Kim Brear, Streetscene and Housing

Name of meeting: District Committee – Kirklees Rural Public Meeting

Date: 25th February 2017

Title of report: Grant application – Roundway Plant it, Grow it, Eat it

Is it likely to result in spending or saving £250k or more, or to have a significant effect on two or more electoral wards?	Not applicable
Is it in the Council's Forward Plan?	Not applicable
Is it eligible for call in by Scrutiny?	Yes
Date signed off by <u>Director</u> & name	Kim Brear, Assistant Director, Streetscene and Housing 13/02/17
Is it signed off by the Director of Resources?	No financial implications
Is it signed off by the Assistant Director – Legal, Governance & Monitoring?	No legal implications
Cabinet member portfolio	Not applicable

Electoral [wards](#) affected: Holme Valley North

Ward councillors consulted: Councillors Charles Greaves, Edgar Holroyd-Doveton and Terry Lyons

Public or private: Public

1. Purpose of report

The Committee is asked to consider a grant application by Roundway & Stoney Lane Tenants and Residents Association (TRA), Honley for £1,500 towards the creation of an easy access fruit and vegetable garden for all the tenants to use.

2. Key points

Background

- 2.0** The project was instigated through the Kirklees Neighbourhood Housing (KNH) plan it, grow it, eat it initiative. Four raised beds will be created for fresh vegetables and an area to grow fresh seasonal fruits such as strawberries, raspberries, gooseberries, rhubarb as well as a small sized greenhouse for propagating. A pathway will be created to the raised beds to ensure access and safety for all participants.
- 2.1** The garden will grow a variety of vegetables for the benefit of all residents in the Association area, supply the twice weekly luncheon clubs, and provide fresh home grown produce for several buffet teas throughout the year, providing cheaper, healthier produce.
- 2.2** All tenants will be encouraged to participate in the vegetable garden regardless of ability and knowledge. The TRA covers over 130 properties. Support will be sought from a range of professionals for advice of what to grow / when as well as suggestions from tenants.

Expected benefits and outcomes

- 2.3** The project will enable those with poor mobility and limb/ back issues to enjoy gardening with very little effect on their health. It will bring people together, helping to reduce social isolation and reduce recourse to NHS/ GP services. Being outdoors will have a positive effect on health and well being, helping participants to improve their confidence and bring a sense of achievement. Using moderate physical strength will assist in reducing blood pressure and improve respiratory health, mental health, agility, bone strength and sociability. The project will encourage team work among the tenants.

2.4 Cost breakdown

Item	Amount requested from district committee	Amount funded from other sources	Total Cost
5 planters	£75	£425	£500
4 raised beds	£500	£700	£1,200
3 compost bins	-	£450	£450
4 tonnes topsoil	-	£400	£400
Compost	-	£100	£100
2 wheel barrows	£50	£50	£100
various gardening tools	£152	£325	£450
Poly tunnel	-	£200	£200
Shed/ tool store – new or repairs	£100	£100	£200
Plants, trees, fruit trees			
Labour/ machinery hire	£600	£1,000	£1,600
Paving stones/ hard core	-	£300	£300
Total	£1,500	£4,150	£5,650

The project was instigated through KNH Plant it, Grow it, Eat it and received an initial £300 funding, with a further amount due in 2017/18. £1,900 was secured through Awards for All with £1,000 granted by Holme Valley Parish Council, due April 1st.

The shortfall of £950 will be met by tenants' fundraising activity, exploring other funding and if necessary reducing costs.

In addition to the cost of the project £2,170 from The Big Lottery Celebrate Fund will be used for a launch event in July, hopefully to involve the school, wider community and supporters of the project.

The KNH Caretaking Team have offered support to the project, but certain activities may involve specialists using specialist machinery / equipment, so a small contingency is included for such costs.

The project hopes to get support from Comoodle for borrowing tools and equipment for the groundwork and developing the site, but need a tool bank on site that is easily accessible to the allotment users for day to day use.

The project will constantly look for best value and negotiate the best prices possible, recycling and reusing whenever practicable. A number of compost bins will be made out of recycled timber and pallets, and manure is free of charge.

2.5 Volunteers

Around 30 volunteers/ 300 hours will be involved as much as possible in the initial groundwork, though professional involvement is essential in developing the infrastructure to ensure pathways and growing areas are safe and fit for purpose in the interest of the wellbeing of all uses. Volunteers will be repairing, planting, growing, picking, distributing and supporting others.

2.6 Timescale

The project will start on 1st March 2017 with preparation taking place through to 1st September 2017, after which it is planned to be ongoing and sustainable.

The groundwork is planned to start the last week in February when the site will be prepared, raised beds and planters built and hard core laid. The work on the paths will be completed in April ready for use in May.

3. Implications for the Council

The TRA is registered with the Council's grant access point. If the grant is approved the group will enter into a grant agreement with the Council.

The application meets the district committee priorities of Health & well being; community food growing projects and Place; communities looking after local assets for all to use and enjoy.

4. Consultees and their opinions

The garden will be on KNH land, KNH is fully supportive of the project.

5. Next steps

If the grant is approved the group will be asked to give feedback on the project.

6. Officer recommendations and reasons

The Committee is asked to consider the grant application.

7. Cabinet portfolio holder's recommendations

Not applicable

8. Contact officer and relevant papers

Julie McDowell, Area & Neighbourhood Co-ordinator

tel 01484 221709

email: julie.mcdowell@Kirklees.gov.uk

9. Assistant director responsible

Kim Brear, Streetscene and Housing

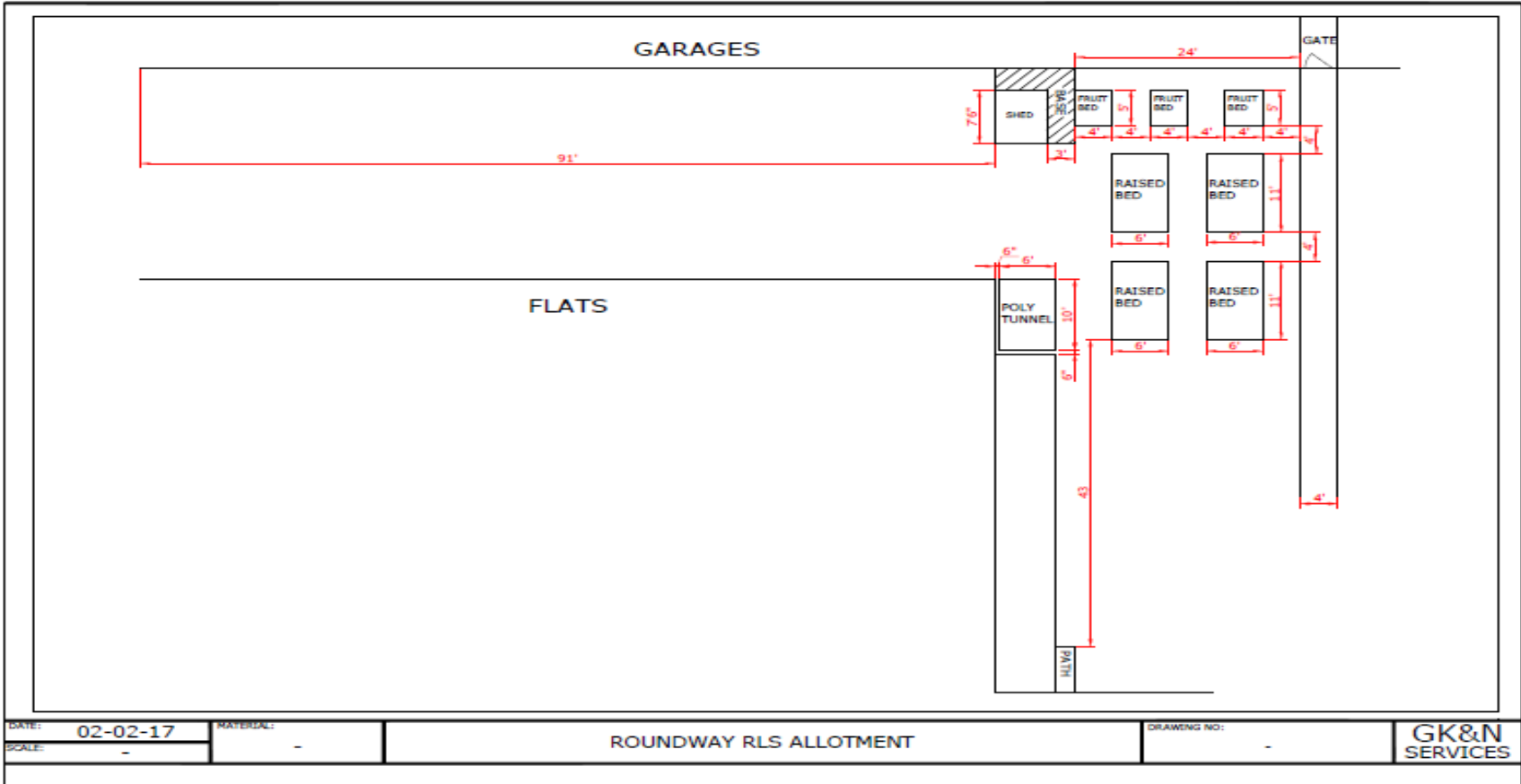





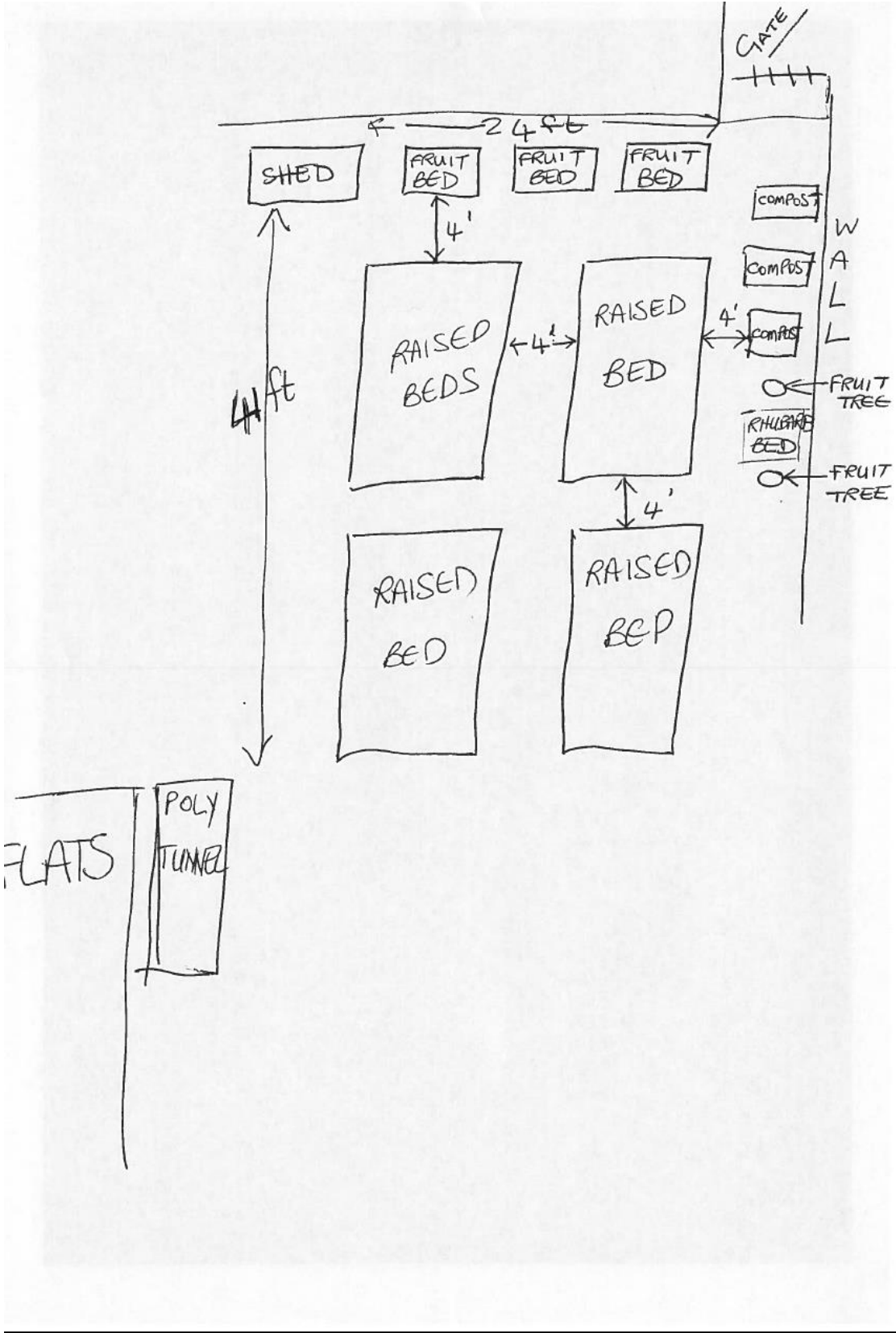



Name of meeting: District Committee – Kirklees Rural Public Meeting

Date: 25th February 2017

Title of report: Grant application – Honley Wood Bridle Path improvements

Is it likely to result in spending or saving £250k or more, or to have a significant effect on two or more electoral wards?	Not applicable
Is it in the Council's Forward Plan?	Not applicable
Is it eligible for call in by Scrutiny?	Yes
Date signed off by Director & name	Kim Brear, Assistant Director Streetscene & Housing 13/02/17
Is it signed off by the Director of Resources?	No financial implications
Is it signed off by the Assistant Director – Legal, Governance & Monitoring?	No legal implications
Cabinet member portfolio	Not applicable

Electoral [wards](#) affected: Holme Valley North

Ward councillors consulted: Councillors Charles Greaves, Edgar Holroyd Doveton, Terry Lyons

Public or private: Public

1. Purpose of report

The Committee is asked to consider a grant application by Kirklees Bridleways Group for £2,000 towards work to create and maintain a bridle path in Honley Wood.

2. Key points

2.0 Kirklees Bridleways Group is a local community group which, over the last three years, has been conducting historical research for evidence on bridleways and footpaths to ensure they are correctly added to the definitive map and statement thereby ensuring their survival for future generations. Work parties clear large areas of brambles, nettles, overhanging branches etc with small hand tools. In the last 12 months 400 hours of volunteering time.

2.1 The Group is planning work to install gates, horse stiles and vehicle barriers at both ends of Honley Wood and will undertake surface repairs. Work will also be done to clear paths of over hanging branches, brambles, nettles, and any thing that makes use of the bridleway and footpaths difficult. The group has borrowed petrol trimmers to clear a number of routes in the Holme Valley. The group is proposing to buy a professional multi tool. It will be used for work with The River Project, Open Spaces Society and South Pennine Pack Horse Trust.

2.2 The work will improve access to Honley Wood and benefit local horse riders, removing them from a long main road, as well as cyclists. Maintenance will encourage more use of the woods and improve disabled access.

2.3 The group has £2k funds currently unallocated but which are planned to be used on research and Definitive Map Modification Orders. The group is currently working on 20 tracks/upgrades.

2.4 Cost Breakdown

Item	Amount requested from District Committee	Amount funded from other sources	Total Cost
Heavy duty horse friendly vehicle barrier both ends of Honley Wood	£1,000	£1,000	£2,000
Professional Stihl multi tool with attachments	£1,000	£1,000	£2,000
Total	£2,000	£2,000	£4,000

The group will contribute £2,000 towards the cost of the items from its own funds. The machinery would be kept in a locked garage, insured and it would have regular services. This multi tool would be used by males only, wearing gloves, integrated forestry helmet and goggles.

2.5 Timescale

The work to improve the bridle path will start at Easter 2017 and take 2 weeks.

2.6 Volunteers

Kirklees Bridleways Group is a local voluntary community group with about 100 members. It organises voluntary work parties most weekends throughout the Summer. 20 volunteers will take 800 hours in total to install the new gates and undertake pruning, trimming, brush cutting, hedge trimming, rubbish collecting, tidying and safety assessment.

3. Implications for the Council

Kirklees Bridleways Group is in the process of renewing registration with the Council's Grant Access Point. If the grant is approved the group will enter into a grant agreement with the Council which includes a clause that groups make available on Comoodle for other groups to borrow any equipment purchased with district committee funding, as appropriate.

The application meets the district committee criteria of Place; communities looking after local assets for all to use and enjoy and Health and wellbeing.

4. Consultees and their opinions

The group will seek permission from the landowners Myers to do the work, the bridle path will be a permissive route.

Kirklees PROW supports schemes to widen access for horse riders.

Holme Valley North Ward Councillors have been consulted.

5. Next steps

If the grant is approved the group will be asked to give feedback on the project.

6. Officer recommendations and reasons

The Committee is asked to consider the application with any funding approved subject to completion of the GAP registration.

7. Cabinet portfolio holder's recommendations

Not applicable

8. Contact officer and relevant papers

Julie McDowell, Area & Neighbourhood Co-ordinator, Tel 01484 221000 email: julie.mcdowell@kirklees.gov.uk

9. Assistant director responsible

Kim Brear, Streetscene and Housing

Name of meeting: District Committee - Kirklees Rural Public Meeting

Date: 25th February 2017

Title of report: Grant application – Holmbridge Cricket Pavilion

Is it likely to result in spending or saving £250k or more, or to have a significant effect on two or more electoral wards?	Not applicable
Is it in the Council's Forward Plan?	Not applicable
Is it eligible for call in by Scrutiny?	Yes
Date signed off by <u>Director</u> & name	Kim Brear, Assistant Director Streetscene & Housing, 13/02/17
Is it signed off by the Director of Resources?	No financial implications
Is it signed off by the Assistant Director – Legal, Governance & Monitoring?	No legal implications
Cabinet member portfolio	Not applicable

Electoral [wards](#) affected: Holme Valley South

Ward councillors consulted: Councillors Donald Firth, Nigel Patrick and Ken Sims

Public or private: Public

1. Purpose of report

To consider a grant application by Holmbridge Cricket Club for £3,270 revenue contribution to complete works to the Cricket Pavilion and Club House.

2. Key points

2.0 Background

Holmbridge Cricket Pavilion has been undergoing work to improve the fabric of the building. £89k funds raised by the club so far have been used to get the building into a good state of repair and modernize the ground floor. Additional works which were not anticipated (to the roof and foundations) have increased the costs. This has left a shortfall of £3,770 to complete the first floor accommodation with female and umpire changing rooms.

2.1 The current pavilion was last modernized in 1980 and is no longer fit for purpose with some areas unsafe to use. Modernization works will provide two new changing rooms with integral showers, a kitchen which will allow improved catering for both the cricket and football clubs, a new social area and bar for players/supporters and public, new indoor public toilets, and a score box that is safe to use. It will also incorporate the installation of a heating system and new electrics to comply with current standards, and an improved external viewing area. *Photos of the current facilities are appended.*

2.2 Expected benefits and outcomes

A modernized facility would enable the Cricket and Football Club to keep the existing players it has and run the current 8 teams. Improved facilities will allow both clubs to implement their Sports Development Plans of increasing the number of junior teams through maintaining the U9's, U11's, U13's, U15's and U17's junior cricket teams along with the establishment of a junior section of the football club.

A potential impact of **not** modernizing the club house would be to lose some of its junior players to other clubs that may have better facilities, not just in terms of training equipment and coaching, but in terms of club house facilities. For the senior players not having modern club house makes it difficult to not only retain the current players but also to attract new players to the club.

Modernisation of the pavilion would substantially improve the attractiveness of the clubs to the local community. The majority of the junior and senior players of both clubs, committee members and volunteers are from the local community. Over the last few years this has widened to incorporate adjoining communities through the success of the junior set up within the cricket club, and this is something the football club also wishes to emulate.

A modernised pavilion will allow both clubs to host events themselves, including joint events, and so bringing together the community. It will provide a smaller venue within the heart of the community for such events as children's parties, club meetings, OAP meetings and gatherings as well as offering a place for other clubs to meet if required. There are three schools in the area and one pre-school that would also consider using the improved facilities if they were made available for sports days and summer fairs etc.

The playing relationship with the Holme Valley Girls Cricket Club could also be enhanced further by offering them the opportunity to use the ground for games and training. It may also attract more girls to play cricket through the junior teams as they will have their own secure changing facilities. This again is something that has not been promoted widely to-date.

The whole of the ground floor will be DDA compliant so accessible to people with disabilities. There will be a disabled accessible toilet.

In the local community the club has established that there are several families with children with complex needs and adults with disabilities. They are currently unable to access sports facilities in their local area without driving, particularly in the Holme, Holmbridge and Hinchcliffe Mill area. The improved facilities would enable these vulnerable children, young people and adults to access activities and facilities which will improve their physical and mental health through increasing their access to sports activities, community events and outdoor space.

2.3 Sustainability

The modernized facilities will be used year round by both clubs. They will be run by a joint committee made up of members of both clubs. The club committees meet on a monthly basis.

The modernization of the pavilion will allow the clubs to enhance current income substantially by attracting more members.

A modernized pavilion will allow a number of the fund raising events currently held by the clubs in alternative venues, such quiz nights and race nights, to be held within the club.

Improved catering facilities and a small bar will increase the income to the Club substantially.

The Club's Committee will be able to explore the possibility of working with other sporting and social organisations in the community providing an alternative meeting place.

The Club also has strong links with a Sports Coaching Company - Project Sport - sports within schools and sports clubs out of schools. The ground and facilities would be available to hire to run cricket coaching sessions etc. (Project Sport has provided support to this project.)

Providing such sporting coaching during school holidays would be a fantastic benefit as it would allow a number of people the ability to try new sports in their local area, on their doorstep, for both young and old alike.

It would also encourage cricket supporters in the community to come and watch a game of senior or junior cricket and enjoy the facilities and refreshments from a comfortable viewing area - something that was once an integral part of community life.

2.4 Cost breakdown

Item- Completion of first floor scorer area, female/ umpires & referee changing facilities, store rooms materials & labour	Amount requested from District Committee	Amount requested from other sources	Total Cost
Plumbing works	£1,710	-	£1,710
Stud walls (plaster boards & finish)	£500	-	£500
Floor covering	£560	-	£560
Electrics	£500	£500	£1,000
Total	£3,270	£500	£3,770

The total cost of the project is £89k excluding the work to the 1st floor; the club has contributed £5,000 and obtained grants from Sports England, Huddersfield Common Good Trust and Holme Valley Parish Council. The work to the upper floor would be done by the plumbing and electrical contractors engaged to do the work on the ground floor.

2.5 Timescale

The initial work started on 14th December 2016 is expected to take 12-14 weeks. Work to complete the upper floor would start in March 2017 if funding is in place.

2.6 Volunteers

Over 20 volunteers are involved in the project undertaking various manual handling operations such as moving materials, removal of rubbish from the site and 2 volunteers are working with the building contractor on day to day management. A total of 200-250 hours for the whole project.

3. Implications for the Council

The group's Grant Access Point registration with the Council is currently being renewed. If the grant is approved the group will enter into a grant agreement with the Council.

The application meets the District Committee priorities of Health and well being; access to physical activity in local communities and Place; communities looking after local assets for all to use and enjoy.

Planning permission for the pavilion works was granted in August 2016, for a single storey extension and external staircase, alterations to roof height, dormer and decking. The land is owned by the cricket club. *Copy of plan is appended.*

4. Consultees and their opinions

The Council's Sports and Physical Activity Team –“this seems to be a very reasonable project, with significant benefits to the local community and for participation in football and cricket in particular. There is clearly significant input from the club in terms of monies and in lieu of monies (volunteering to keep building costs down etc) so I would be supportive of this bid to help them fill the shortfall they are faced with.”

Ward Councillors are supportive of the project.

5. Next steps

Subject to approval of the grant the funding will be paid to the group and feedback will be provided.

6. Officer recommendations and reasons

The Committee is asked to consider the application, with a decision to fund being subject to completion of the GAP renewal process.

7. Cabinet portfolio holder's recommendations

Not applicable

8. Contact officer and relevant papers

Julie McDowell, Area & Neighbourhood Team,
 Tel 01484 221000
 email: julie.mcdowell@kirklees.gov.uk

9. Assistant director responsible

Kim Brear, Streetscene and Housing

Photos / plans appended

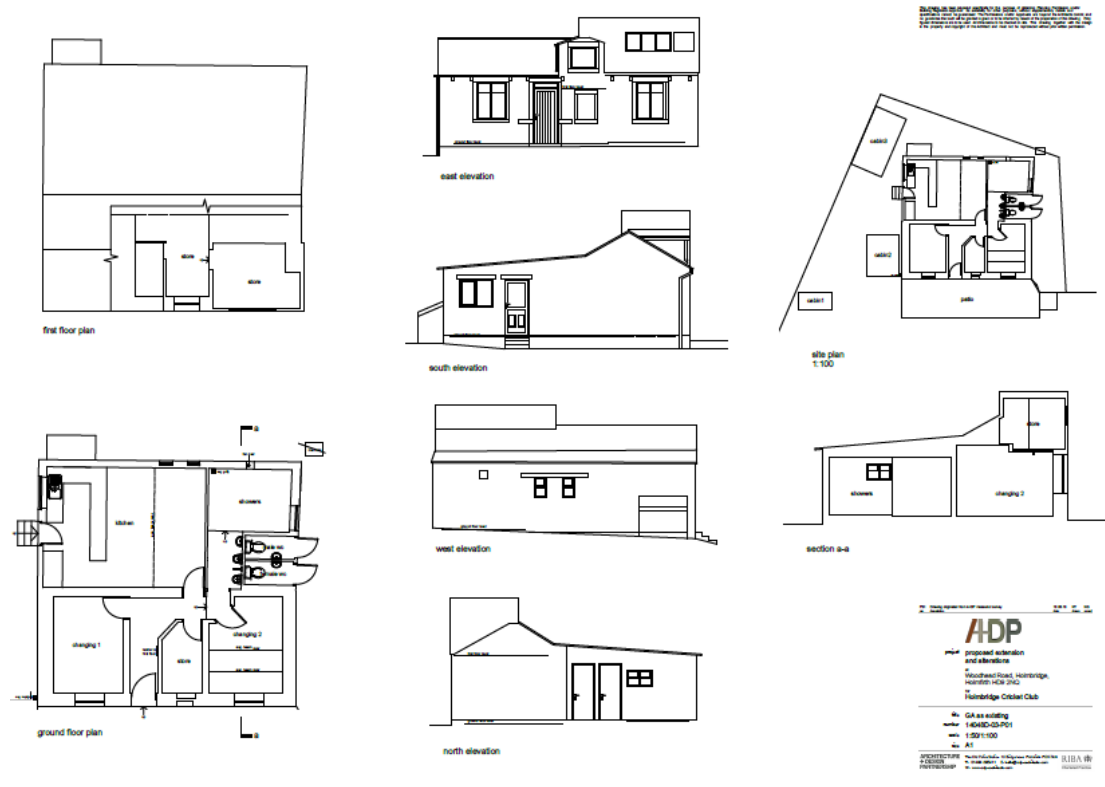

View from Woodhead Road



View from Woodhead Road



Front Elevation



The score box was an addition in the early 1970's - the roof leaks and the floor is now deemed unsafe rendering this area unusable

Access to the outside public WC's



The only Ladies WC is accessed this way.

There is a Male WC next to the Ladies for the public, and only a male WC inside the building.

No Disabled WC

Gents WC - the door is Broken and currently does not close properly.



Access doors to the agents and Ladies WC's



Ladies WC - this is the only ladies WC.



Front Elevation



Front Elevation



There is currently no disabled access to the club as there is no ramp

Side Elevation with access to the Kitchen area



Side Elevation



The building need's re-painting.

The green container is one of the two external storage containers for the lawn mower and other grounds mans equipment, and Cricket training equipment.

Entrance to the Kitchen from the side elevation



Kitchen and Canteen Area



There is no gas so there is limited facilities.

Damp in the Kitchen under the kitchen counter



Hole in the Kitchen Ceiling



Damp adjacent to the exit door from the Kitchen



Damp and Mould in the kitchen cupboards



Damp under the kitchen sink on the external wall



Canteen Area



Inefficient T12 lights which are very inefficient to run

Rear Elevation



Side Elevation



The two external storage containers for the grounds mans equipment and the cricket training equipment

Patio to the front of the Pavillion



There are a number of such loose flags in this area.

There is no ramp to this area and then the Pavillion so restricting disabled access.

Patio area to the front of the Pavilion



Entrance Door to the Pavilion



Access to the now unsafe score box.



Unsafe Score Box Area



Unsafe Score Box Area



Issue 28



Changing Room 1



This photo was taken prior to the cricket season and is being used by Holmbridge Football Club on this day.

Changing Room 1



Poor state of decorative repair

Changing Room 1



Changing Room 1



Poor state of decorative repair.

Inefficient T12 lighting.

Internal Store Room



Entrance to Showers and the Internal Male WC



Changing Room 2



Poor state of repair

This is located under the score box - which is now unsafe

Changing Room 2



Poor state of repair

Changing Room 2



Poor state of repair

Changing Room 2



Poor state of repair

Changing Room 2



Poor state of repair

Changing Room 2



Poor state of repair

Changing Room 2



Poor state of repair

Changing Room 2



Poor state of repair

Changing Room 2



Damp on the external wall

Showers and Male WC's



Showers



Only half the showers work as the boiler and pump can not run all of them at once.

Showers



Poor state of repair

Showers



Only external window

Showers



Damp and Mould on the ceiling due to poor ventilation



Name of meeting: District Committee – Kirklees Rural Public Meeting

Date: 25th February 2017

Title of report: Outreach Advice Provision in 2017/18 - Skelmanthorpe

Is it likely to result in spending or saving £250k or more, or to have a significant effect on two or more electoral wards?	Not applicable
Is it in the Council's Forward Plan?	Not applicable
Date signed off by Director and name	Kim Brear, Assistant Director Streetscene & Housing , 13/02/17
Is it signed off by the Director of Resources?	No financial implications
Is it signed off by the Assistant Director – Legal, Governance & Monitoring?	No legal implications
Is it eligible for call in by Scrutiny?	Yes
Cabinet member portfolio	NA

Electoral [wards](#) affected: Denby Dale
Ward councillors consulted: Jim Dodds, Graham Turner, Michael Watson
Public or private: Public

1. Purpose of report

To consider an extension to the Citizens Advice Bureau (CAB) outreach service in the Denby Dale ward for a 12 month period, 1st April 2017 to 31st March 2018.

2. Key points

2.0 In addition to the current Advice Contract funded by Kirklees Council the district committee has funded outreach sessions in the Denby Dale ward for the last 6 years. The Council's contract provides for an advice service across Kirklees via the telephone advice line and for face to face appointments in Dewsbury and Huddersfield centres.

- 2.1** An outreach service in Denby Dale ward provides for an adviser being available once a fortnight, on Wednesdays 10 am to 1 pm for appointments with clients at Skelmanthorpe library.
- 2.2** Clients contact the telephone advice line service and receive an initial assessment. If an appointment is required and the client is based in the Denby Dale area they are offered the next appointment at the library. Clients usually have a 45 minute appointment slot although double appointments can be booked for form filling etc.
- 2.3** Quarterly reports on progress are made to the Denby Dale ward councillors on the numbers using the service and outcomes.

2.4 Monitoring information 2016/17

For the period April 2016 to January 2017:-

- 128 Denby Dale residents have called our telephone advice service for help
- 45 of these were given a telephone call back from our outreach adviser to get more in depth information
- 12 of these were helped over the phone only
- 33 people were given appointments at Skelmanthorpe Library during the 13 outreach sessions
- The income gains for the 33 clients seen at Skelmanthorpe are £55,000, an average of over £1,600 per client per annum.

The main enquiry area tends to be benefits but other issues we have offered advice on include; housing, debt, consumer, employment and health.

From April 2013 to December 2016 we have helped face to face over 159 clients in the Denby Dale area at a cost of £14,544. This amounts to £91 per client. We have also supported many other Denby Dale residents who have used our telephone advice service (see section 2.2)

2.5 Costs

One session per fortnight held at Skelmanthorpe Library will cost £4,475 in 2017/18. This is the same cost as 2016/17.

3. Implications for the Council

The proposal meets the Council priority of social action, supporting people to take actions for themselves. There is inequality of access to advice for people living in the Denby Dale ward compared to the average across Kirklees.

4. Consultees and their opinions

Ward councillors are proposing to continue funding this provision in 2017/18 on the same basis as in previous years.

Kirklees Revenues and Benefits Service has been informed of the proposals.

5. Next steps

Subject to a decision to fund this the outreach sessions will be booked at the library and staffing allocated.

6. Officer recommendations and reasons

To agree funding of £4,475 revenue to continue to deliver one outreach advice session on a fortnightly basis at Skelmanthorpe Library 1st April 2017 to 31st March 2018.

7. Cabinet portfolio holder's recommendations

Not applicable

8. Contact officer and relevant papers

Julie McDowell, Area & Neighbourhood Co-ordinator, Tel 01484 221000 email julie.mcdowell@kirklees.gov.uk

9. Assistant director responsible

Kim Brear, Streetscene and Housing



Name of meeting: District Committee - Kirklees Rural Public Meeting

Date: 25th February 2017

Title of report: Grant application - improvements to the Kirkburton Spur of the Trans Pennine Trail

Is it likely to result in spending or saving £250k or more, or to have a significant effect on two or more electoral wards?	Not applicable
Is it in the Council's Forward Plan?	Not applicable
Is it eligible for call in by Scrutiny?	Yes
Date signed off by <u>Director</u> & name	Kim Brear, Assistant Director Streetscene & Housing 06/02/17
Is it signed off by the Director of Resources?	No financial implications
Is it signed off by the Assistant Director – Legal, Governance & Monitoring?	No legal implications
Cabinet member portfolio	Not applicable

Electoral [wards](#) affected: Denby Dale and Kirkburton
Ward councillors consulted: Councillors Jim Dodds, Graham Tuner, Michael Watson, Bill Armer, Richard Smith and John Taylor

Public or private: **Public**

1. Purpose of report

To consider a grant application by Denby Dale Walkers are Welcome Group for £8,252 contribution towards work to improve the surface of the Kirkburton Spur, an extension to the Trans Pennine Trail from Kirkburton to Penistone.

2. Key points

2.0 The Kirkburton Spur was created with £144,000 EPIP funding under the LEADER programme 2009-2013. Both an on road and off road route were provided to give a welcome link from Kirklees to the nationally renowned Trans Pennine Trail. EPIP funding enabled the design, procurement and signage of two links between Denby Dale/ Kirkburton and the Trans Pennine Trail near Penistone.

- 2.1** The new project will improve two sections of bridleway on the off- road route which are becoming virtually impassable at certain times of year for all but the most dedicated mountain biker. These are at Bank Lane, Denby Dale and at Long Lane, Thunderbridge. *Maps of the routes are attached.*
- 2.2** The success of the link has enhanced the growing reputation of the Denby Dale/ Kirkburton area for outdoor recreation. The Trans Pennine Trail is of national importance and has boosted the rural economy of businesses along its route. *A letter of support is attached which shows visitor spend in this area by walkers and cyclists using the route. Letters of support are also attached from local businesses.* The project will increase the numbers using the route and strengthen the profile of the area as an outdoor visitor destination. The route is used by walkers, cyclists and horse riders.
- 2.3** The work at Long Lane, Shepley will involve reconstructing a 50 metre section of the bridleway using the existing cobbles and installing drainage. The work at Bank Lane, Denby Dale will involve excavation of a spoil, resurfacing, cleaning drains and adding 2 metres of concrete. Three quotes were obtained for each section. The lowest quotes have been selected by the group; £25,180 plus VAT for Long Lane and £9,200 plus VAT for Bank Lane. *Copy of the preferred quotes/ contractors attached.*

2.4 Cost breakdown

Item	Amount requested from District Committee	Amount requested from other sources	Total Cost
Materials and labour for Long Lane reconstruction; cobblestones, concrete, hard core, dressing, pipes, drain tops/ gully traps, waste disposal, plant hire	£5,000	£25,216	£30,216
Materials and labour for Bank Lane reconstruction; spoil removal, planings, crushed stone, concrete, use of digger/ dumper	£3,252	£7,988	£11,240
Total (includes VAT)	£8,252	£33,204 (EPIP application)	£41,456

An application for 80% of the cost of the work has been made to the East Peak Innovation Partnership (EPIP) fund. This is the maximum amount that EPIP could fund. The outline application to EPIP has been approved. The full application to EPIP will be submitted by 10th February 2017 and a decision made shortly after.

2.5 Timescale

The work is planned to start on 1st March 2017 and is expected to take 3 weeks.

2.6 Volunteers

Ten volunteers from the Group will assist with the planning and organising of the project and will keep the route clear of overhanging vegetation. This is a total of 150 volunteer hours.

3. Implications for the Council

All the work will take place on Public Rights of Way. Kirklees Public Rights of Way Team gives permission for the works on both sections of the route –“maintenance of the improved surface of the route will remain the responsibility of Kirklees Council, as Highway Authority, unless altered without permission by others.”

The application meets the district committee priority of Place; footpaths, roads and greenway improvements, Economic Growth & Regeneration; contributing to the rural economy and local tourism and Health and well being; access to physical activity in local communities.

Denby Dale Walkers are Welcome Group is registered with the Council's Grant Access Point. If the grant is approved the group will enter into a grant agreement with the Council.

4. Consultees and their opinions

The Denby Dale and Kirkburton ward councillors have been consulted and are all supportive of the application.

Councillor Bill Armer: “I support this in principle. I am currently dealing with complaints of off-road motorbikes on the Long Lane section. Difficult to improve access for equestrians without making the route more attractive to off-road motorcycles, but I wonder if there is anything which could be incorporated into the scheme.”

5. Next steps

Subject to confirmation from EPIP that the match funding is in place the amount of £8,252 would be released up front to allow the Group to purchase materials to enable the work to start. EPIP funding can only be released once the work has been done.

6. Officer recommendations and reasons

The Committee is asked to consider the application.

7. Cabinet portfolio holder's recommendations

Not applicable

8. Contact officer and relevant papers

Julie McDowell, Area & Neighbourhood Co-ordinator, Tel 01484 221000
email julie.mcdowell@kirklees.gov.uk

9. Assistant director responsible

Kim Brear, Streetscene and Housing

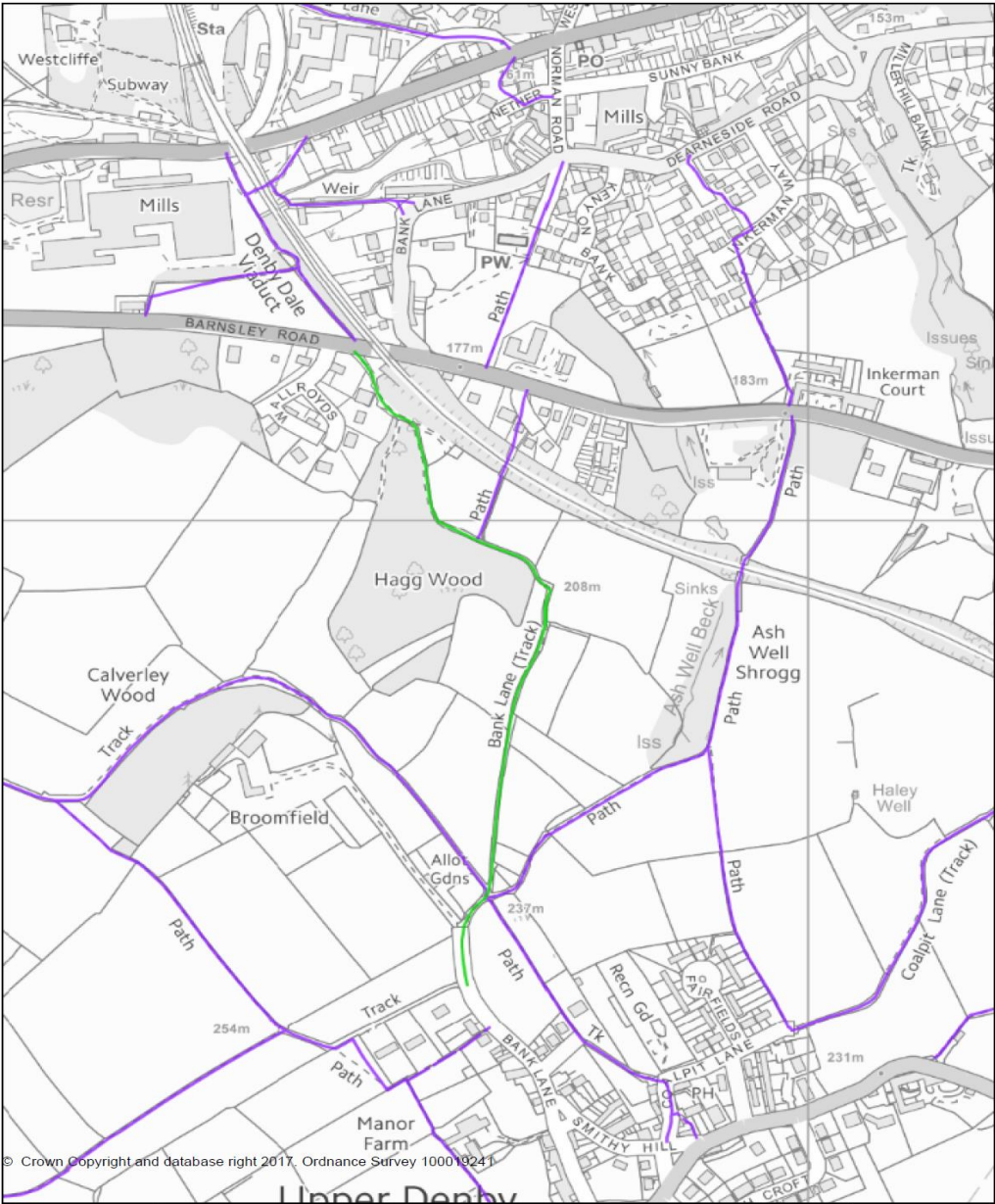

© Crown Copyright and database right 2017. Ordnance Survey 100019241

Kirkles
COUNCIL
Kompass
Kirkles Mapping Service
Tel: 01484 221757 (Internal 860)
1757/E-Mail: maps@kirkles.gov.uk

Bank Lane
100 m
Scale = 1 : 5000



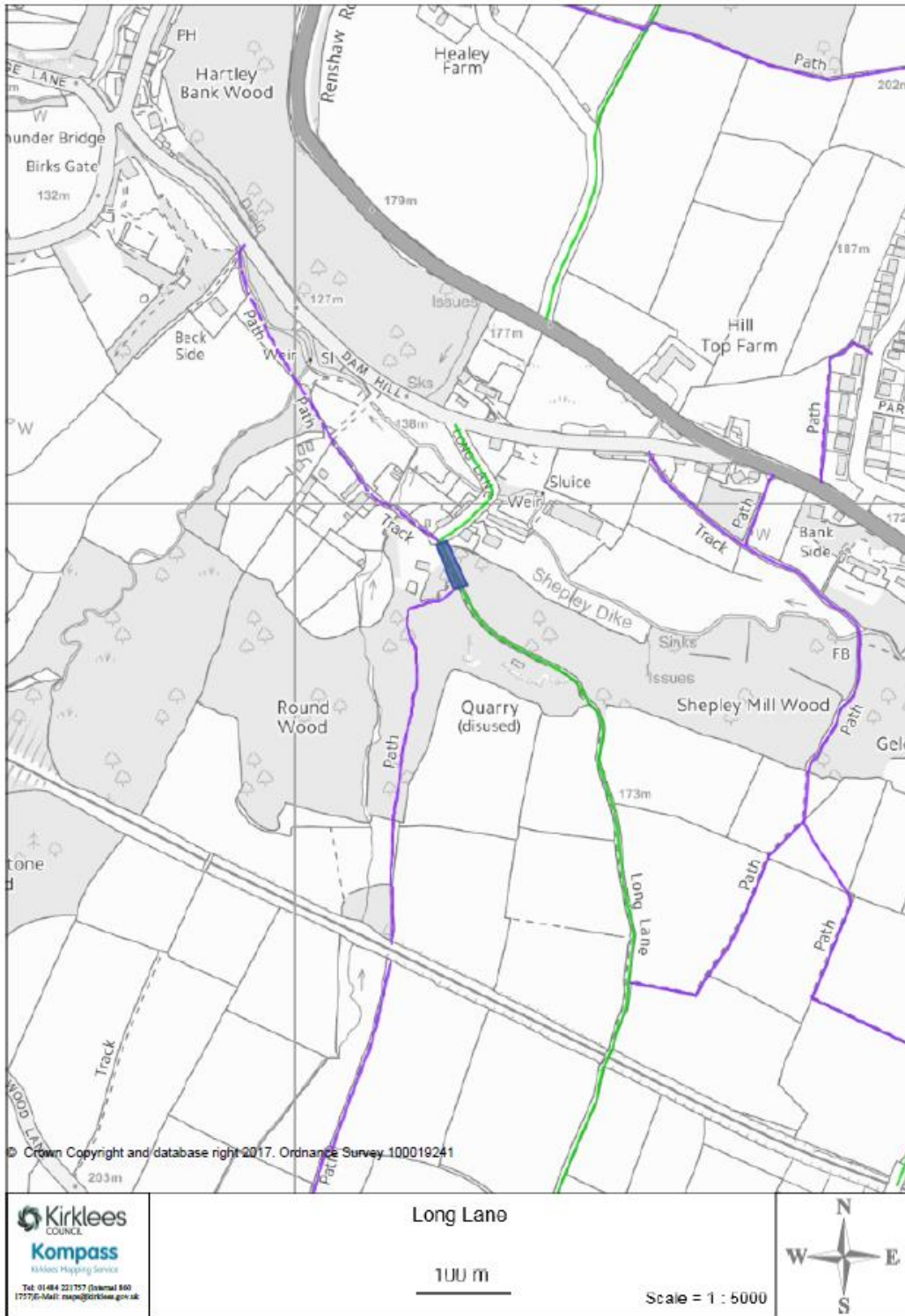

THE GEORGE INN

Upper Denby

Richard Brook
Denby Dale Walkers Are Welcome

Monday 9th January 2017

Dear Richard,

I am writing to you with regard to the Denby Dale Walkers Are Welcome group and the sterling work that they have done over the last few years in and around the area.

As the licensee of The George Inn, the village pub in Upper Denby, it is always great to see initiative and community spirit within and beyond our village.

As a wet-led public house in a rural location encouraging visitors to the area is important to us and of considerable benefit to our business.

In recent years we have seen a number of new small businesses start up in Denby that all offer accommodation to visitors to the area. Manor Farm Cottage Self Catering, Broomfield Cottage Self Catering and most recently Holly Tree Cottage, a Caravan Club site.

The main attraction for the majority of people choosing to visit and stay in our area is undoubtedly the beautiful countryside that we have on our doorstep and the many footpaths and bridleways that we are lucky enough to have that enable people to get out and enjoy it. Indeed these paths are also enjoyed by an increasing number of local people.

We lead regular Pie & Pea Walks from The George, as well as attracting local walking groups and ramblers, and an increasing number of cyclists, particularly since the Grand Depart, Tour de Yorkshire and the British Cycling Yorkshire Road Race Championships. We host walks for the local East Peak Walking Festival every year organised by EPIP and last year saw the first Denby Dash, a fundraising run which uses the public footpaths in Denby.

The Walkers Are Welcome group have made huge improvements to the network of paths in our area and any future improvements that help to link Denby to Denby Dale for walkers and cyclists can only be a good thing for our business, particularly in a financial climate that has seen many hundreds of rural village pubs close over the last few years.

Thank you for all your efforts to date and we look forward to welcoming more 'muddy boots' in the coming year.

Please feel free to forward this letter on to anyone that it may concern.

With best wishes

The George Inn, 114 Denby Lane, Upper Denby, Huddersfield HD8 8UE
Tel: 01484 861347
www.thegeorgeinn-upperdenby.co.uk
email: info@thegeorgeinn-upperdenby.co.uk

WRAP 'N' ROLL
Unit 16 a
Denby dale ind park
Wakefield Road
Denby dale
Huddersfield
HD8 8QH

[Tel:-01484 865784](tel:-01484865784)

Hi Richard

I would just like to thank you for the amount of hard work and time you have invested into denby dale walkers are welcome group.

It has been a great boost to my business with the walkers in the area, not only calling for the little booklets but also drinks sandwiches etc , quite a few walkers have also shown interest in buffets so that line of trade has been boosted as well .

We also benefit from cyclists that are passing through with the same routes to follow. I do so hope you are able to continue to build and mend these bridle paths and public foot paths as it has brought great business to the village and my business.

My sales benifits especially this time of year when there are plenty walkers about and they seem to be growing year on year.

Thanks
All the best

Vicky marsden



3rd February 2017

To whom it may concern

I would strongly support any assistance in helping improve bridleway surfaces in and around the Denby Dale area for the benefit of both walkers and cyclists.

Since opening Denby Dale Tea Rooms in 2013 we are seeing an increasing number of customers on a regular basis that both walk and cycle. Having walking parties of up to 15 people has not been unknown and only last Sunday did we get a group of 24 cyclists drop in on us. Kirkburton cyclists visit us with their new/beginner groups along with cyclists coming from Sheffield on occasional Saturday mornings.

Kind Regards

Jared Wood

Jared Wood

Manager

Denby Dale Tea Rooms

29th November 2016

Trans Pennine Trail



Hosted By:
Barnsley Metropolitan Borough Council,
PO Box 597,
Barnsley, S70 9EW
Tel: 01226 772574
E-mail: info@transpenninetrail.org.uk
Website: www.transpenninetrail.org.uk

TO WHOM IT MAY CONCERN
EPIP

Trans Pennine Trail – link to Kirkburton

On behalf of the Trans Pennine Trail I would like to submit this letter as evidence to support the bid for EPIP funding. It is understood that this project will enable improvements to two sections of bridleway on the off-road section of the Trans Pennine Trail.

The project will bring much needed enhancement work and added value to the Trans Pennine Trail in this area, particularly in regards to rural tourism income.

In 2012 the Trans Pennine Trail partnership successfully bid for EPIP funding to enable an on-road and off-road spur to be created from Penistone through to Kirkburton. The off-road section is a bridleway but is need of further funding to enable enhancements to provide better facilities for members of the community to enjoy. Currently the route is very challenging for even the most experienced user and these works will enable a more useable route for all members of the community.

The group will engage closely with local communities who have a diverse range of knowledge about the Trail, both locally, regionally and nationally. A major source of community engagement will come from local Volunteer Rangers and the local Penistone to Denby Dale volunteer group.

The Trans Pennine Trail / Sustrans Volunteers along this section to date in 2016 have carried out 70 hours of work. Sustrans deem every hour a volunteer spends out on the route = £12.75, which provides £892.50 in addition to the bid.

As the project aims to provide enhancements to the Trans Pennine Trail, this will in turn benefit the mental and physical health of the local community by providing better facilities on the Trail, a free facility for everyone to enjoy regardless of income or background. By providing these local improvements, this will also be

**Winner of the *Amazing Space* category in the 2006 National Lottery Awards
& Winner of Sustrans UK's Favourite Long Distance Route Award 2015**

of benefit to the Trans Pennine Trail nationally and encourage visitors from further afield to use the spur to Kirkburton. This will attract further visitor spend which is vital in communities along the Trail.

As the Trans Pennine Trail is a sustainable transport route the improvements towards the climate change agenda in reducing carbon emissions is also a positive statement that encourages local sustainable travel along the route.

Evidence can be provided of the local interest in the Trail in this region with the visitor counters and visitor spend data collected by the Trans Pennine Trail national office.

2015 and 2016 data to date indicates the following:-

2015

	Upper Denby		Skelmanthorpe	
	Walk&Cyclists	Spend	Walk&Cyclists	Spend
Jan-15	358	£1,591	2433	£10,813
Feb-15	265	£1,178	2776	£12,338
Mar-15	389	£1,729	3256	£14,471
Apr-15	894	£3,973	3899	£17,329
May-15	1176	£5,227	3755	£16,689
Jun-15	1254	£5,573	3803	£16,902
Jul-15	1866	£8,293	4335	£19,267
Aug-15	1922	£8,542	4155	£18,467
Sep-15	1326	£5,893	4421	£19,649
Oct-15	955	£4,244	2776	£12,338
Nov-15	276	£1,227	1587	£7,053
Dec-15	187	£831	1250	£5,556
Total	10868	£48,302	38446	£170,871

2016

	Upper Denby		Skelmanthorpe	
	Walk&Cyclists	Spend	Walk&Cyclists	Spend
Jan-16	421	£4,349	2,999	£30,980
Feb-16	343	£3,543	2,768	£28,593
Mar-16	432	£4,463	3,570	£36,878
Apr-16	613	£6,332	3,998	£41,299
May-16	956	£9,875	4,254	£43,944
Jun-16	822	£8,491	3,587	£37,054
Jul-16	1243	£12,840	3,225	£33,314
Aug-16	1422	£14,689	3,788	£39,130
Sep-16	1187	£12,262	3,558	£36,754
Oct-16	0	£0	0	£0
Nov-16	0	£0	0	£0
Dec-16	0	£0	0	£0
Total	7439	£33,062	31747	£327,947

**Winner of the *Amazing Space* category in the 2006 National Lottery Awards
& Winner of Sustrans UK's Favourite Long Distance Route Award 2015**

I hope this letter and the evidence provided within can be taken as support from the Trans Pennine Trail partnership to the bid.

If any further information is required regarding the national Trans Pennine Trail route, please contact me on the above details.

Yours faithfully

A handwritten signature in cursive script that reads "Mandy Loach".

Mandy Loach
Trans Pennine Trail Officer

tel: 07831 619711
127 denby lane, upper denby, huddersfield hd8 8un

stevenslater
contracting

Quotation

2.6.10

BACK HALL, DEBIDALE / UPPER DEBID.

10 EXCAVATION OF SPOIL.

DIGGER, DUMPER

3 MEN FOR 2 WEEKS.

40 TONNES OF PLAININGS.

40 TONNES OF CRUSHED STONE.

TIPPING OF SPOIL

CHURN DRAINS + JETTING

2 METRS OF CONCRETE.

TOTAL PRICE. £9200.00 + D.A.T.

HOPING THIS MEETS YOUR REQUIREMENTS

STEVEN SLATER.

tel/fax: 01484 861758 | email: stevenslater57@gmail.com | web: www.denroydfarm.co.uk

VAT Reg. No. 566 9471 54





Denby Dale walkers are welcome group.
83 Barnsley Road
Upper Cumberworth
Huddersfield
HD8 8AP

24.1.2017

Quote / Estimate.

Works: Public bridleway reconstruction 50m of as per spec.

Material

Cobble Stone
Concrete water cut off bars
Concrete
Hard core
10mm Top dressing
Land drain pipe
Concrete pipe sections
Drain tops
Drain gully traps
Plant hire
Waste removal & disposal

Total Materials £12,936.00

Labour

Total Labour £17,280.00

Total £30,216.00

Please note:

Certain products are non stocked items. Therefore we would require an acceptable Deposit on instruction/order.

E&O.E.



Creative Landscape Solutions
West Royd Cottage, Marsh Lane Top, off Gatefoot Lane, Shepley, Huddersfield, West Yorkshire, HD8 8AZ
Tel: 01484 683709 **Mob:** 07748 768353
Proprietor: Robert Barrett



Name of meeting: District Committee – Kirklees Rural Public Meeting

Date: 25th February 2017

Title of report: Grant application – Slaithwaite Civic Hall heating system

Is it likely to result in spending or saving £250k or more, or to have a significant effect on two or more electoral wards?	Not applicable
Is it in the Council's Forward Plan?	Not applicable
Is it eligible for call in by Scrutiny?	Yes
Date signed off by <u>Director</u> & name	Kim Brear, Assistant Director Streetscene & Housing, 13/02/17
Is it signed off by the Director of Resources?	No financial implications
Is it signed off by the Assistant Director – Legal, Governance & Monitoring?	No legal implications
Cabinet member portfolio	Not applicable

Electoral [wards](#) affected: Colne Valley

Ward councillors consulted: Councillors Donna Bellamy, Nicola Turner and Rob Walker

Public or private: Public

1. Purpose of report

To consider a grant application by Slaithwaite Civic Hall Trust for £12,000 revenue towards a new boiler at Slaithwaite Civic Hall.

2. Key points

2.0 The asset transfer of Slaithwaite Civic Hall from the Council to the Slaithwaite Civic Hall Trust is under discussion. Building surveys (electrics, plumbing and heating) have identified faults with the boiler and heating system. The Trust's draft business plan 2017-2020 identifies that the boiler is a priority to repair or replace.

- 2.1** A new boiler and heating system would be more eco-friendly, save on costs and provide a warm, welcoming environment for the benefit of the community. A reliable heating system would encourage more people to make bookings and generate income. This investment would include the ability to isolate areas of the building needing heat when in use, saving on costs. Long term maintenance would be easier and cheaper.
- 2.2** If the boiler is not replaced it is likely to fail in the near future and the building would have to close to bookings. The Trust would have to find funding for repairs and maintenance.

2.3 Cost breakdown

Item	Amount requested from district committee	Amount requested from other sources	Total Cost
New boiler	£12,000	-	£12,000
Labour costs	-	£5,000	£5,000
Cleaning & decorating materials	-	£3,400	£3,400
Totals	£12,000	£8,400	£20,400

These costs are based on two quotes received to date from local companies and include VAT. A third quote is being obtained.

The Trust is applying to the Centre for Sustainable Energy for a grant towards the cost of the project and a decision will be made on 1st April 2017.

2.4 Timescales

The work to install the new boiler will take place once funding is in place.

2.5 Volunteers

Between 10 and 20 volunteers will clear the hall before the work takes place and decorate it afterwards. This will take around 5 full days.

3. Implications for the Council

Permission has been obtained from the Council's Physical Resources and Procurement Service and is subject to approval of the asset transfer application by the Trust.

The Slaithwaite Civic Hall Trust is not yet registered with the Council's Grant Access Point. It is a new organisation with a management committee, constitution and 3 year business plan in place with projected cash flow for 3 years.

If the grant is approved the Trust would enter into a grant agreement with the Council. The grant would be paid in two instalments; 75% on proof a contract is in place between the Trust and the contractor to do the work and 25% on proof of completion of the work.

Any grant funding awarded would be held by the Slaithwaite Philharmonic Orchestra on behalf of the Trust. The Orchestra is a main user of the hall and is registered with the Council's grant access point.

The application meets the district committee's priority of Place; communities looking after local assets for all to use and enjoy.

4. Consultees and their opinions

Physical Resources and Procurement – A final copy of the group's business case is awaited for assessment. The process for asset transfer and decision can take anything from 3 months upwards from assessment. The group has been offered a full lease of the premises from 1st April 2017.

Kirklees Legal Services – the asset transfer of Slaithwaite Civic Hall has not yet been approved by Cabinet (Committee Assets) and the business plan of Slaithwaite Civic Hall has not yet been assessed as robust. Slaithwaite Civic Hall Trust is not yet registered as a company, Charitable Incorporated Organisation or incorporated organisation.

Colne Valley Ward Councillors are supportive of the application.

5. Next steps

Subject to approval of the application a grant agreement would be entered into with the group.

6. Officer recommendations and reasons

The Committee is asked to consider the grant application and if approved the release of the grant funding is to be conditional upon completion of the asset transfer on the grounds that reason for the application is that there is going to be an asset transfer, and to be conditional on the set up of Slaithwaite Civic Hall Trust as a Charitable Incorporated Organisation or an incorporated organisation.

7. Cabinet portfolio holder's recommendations

Not applicable

8. Contact officer and relevant papers

Julie McDowell, Area and Neighbourhood Co-ordinator,
Tel 01484 221000
email: julie.mcdowell@kirklees.gov.uk

9. Assistant director responsible

Kim Brear, Streetscene and Housing



Name of meeting: District Committee – Kirklees Rural Public Meeting

Date: 25th February 2017

Title of report: Holme Valley North St. Mary's Mews Honley Parking Bays

Is it likely to result in spending or saving £250k or more, or to have a significant effect on two or more electoral wards?	No
Is it in the Council's Forward Plan?	Not applicable
Is it eligible for "call in" by Scrutiny?	Yes
Date signed off by Director & name	Joanne Bartholomew 09/02/17 Assistant Director Place
Is it signed off by the Director of Resources?	No financial implications
Is it signed off by the Assistant Director – Legal, Governance & Monitoring?	No legal implications
Cabinet member portfolio	Councillor M Khan Highways & Neighbourhoods

Electoral [wards](#) affected: Holme Valley North

Ward Councillors consulted: Councillors Charles Greaves, Edgar Holroyd-Doveton, and Terry Lyons

Public or Private: Public

1. Purpose of report

To agree to fund £7,500 for the construction of parking bays in the roadside verge service margins at St. Mary's Mews, Honley.

2. Key points

Holme Valley North Councillors have been considering solutions to difficulties caused by inconsiderate parking to residents of St. Mary's Mews.

Discussions with officers have determined that any long term solutions would depend on the location of utility apparatus in the grass verges at the entrance to the cul de sac.

There are services in this grass margin as predicted but the override strip would still be possible, although at a slightly reduced width of 800mm. The override strip would consist of 800mm of available running for vehicles plus a kerb to the rear (100mm in width) – 900mm in total. The new kerb is necessary to deter traffic from running off the back of the strip and endangering the resident's fence / churning up the remaining grass.

Topsoil and grass seed to the rear to reinstate the verge area following the works will tidy things up.

The cost of the works will be in the region of £7,500.

3. Implications for the Council

There will not be a future maintenance liability to the council at this time as the bays will not be a part of the adopted highway.

4. Consultees and their opinions

Holme Valley North Councillors are in support of the proposals.

5. Next steps

If approved officers will commission and carry out the works.

6. Officer recommendations and reasons

Officers recommend that by funding this proposal the Kirklees Rural District Committee would demonstrate its continuing commitment to improving the safety and environment for residents in the Holme Valley North Ward.

7. Cabinet portfolio holder's recommendations

Not applicable.

8. Contact officer and relevant papers

Aidan Hopson Principal Technical Officer Place 01484 221000
aidan.hopson@kirklees.gov.uk

[Elizabeth Twitchett – Operations Manager](#) Area Working & Safety:
[01484 221000](tel:01484221000)
elizabeth.twitchett@kirklees.gov.uk

9. Assistant director responsible

Joanne Bartholomew – Assistant Director Place



Name of meeting: District Committee – Kirklees Rural Public Report

Date: 25th February 2017

Title of report: Denby Dale Ward – Litherop Lane, Clayton West - Environmental Improvements

Is it likely to result in spending or saving £250k or more, or to have a significant effect on two or more electoral wards?	No
Is it in the Council's Forward Plan?	Not applicable
Is it eligible for “call in” by Scrutiny?	Yes
Date signed off by Director & name	Joanne Bartholomew 09/02/17 Assistant Director Place
Is it signed off by the Director of Resources?	No implications
Is it signed off by the Assistant Director – Legal, Governance & Monitoring?	No implications
Cabinet member portfolio	Cllr M Khan Highways & Neighbourhoods

Electoral [wards](#) affected: Denby Dale

Ward Councillors consulted: Councillor M Watson consulted and Councillor J Dodds and Councillor G Turner have yet to be consulted

Public or Private: Public

1. Purpose of report

To advise members of the funding arrangements for Litherop Lane, Clayton West - Environmental improvements.

2. Key points

Councillor Michael Watson requested that officers investigated options to reduce the number of incidents of inconsiderate off road parking and littering occurring on Litherop Lane Clayton West. The district committee allocated £1,000 in November 2015 to install kerb stones.

This is the second phase of works and whilst the first stage has very much improved conditions, there is now a need to make a number of minor alterations in order to complete the task.

At this time there are no justifications for funding these works from main stream highways budgets, but officers have considered a number of options available if funding can be secured elsewhere.

Officers from Streetscene & Housing have costed proposals to re-line the carriageway edges in white in order to determine the extent of the road width and it is estimated that these works could be completed for a maximum of £200.

Local stone suppliers Marshalls have offered kerb stones to fill in 10 laybys created by off road parking on the lane. The cost of moving the stones from Shepley Quarry to Litherop Lane is £400 for a full day (price provided by local haulier specialising in this work).

If approved, it is proposed that these works will be funded from the Denby Dale Ward allocation in the Kirklees Rural District Committee Revenue budget.

3. Implications for the Council

There will be a future maintenance liability to the Council for the lining which can be managed from within existing maintenance budgets.

4. Consultees and their opinions

Councillor Michael Watson, residents and officers from Streetscene & Housing.

5. Next steps

Once funding is approved officers will commission the works.

6. Officer recommendations and reasons

Officers recommend that by funding these proposals (£600 in total) the Kirklees Rural District Committee would demonstrate its continuing commitment to improving the environment and the quality of life for residents in the Denby Dale Ward.

7. Cabinet portfolio holder's recommendations

Not applicable.

8. Contact officer and relevant papers

Aidan Hopson Principal Technical Officer

Streetscene 01484 221000

aidan.hopson@kirklees.gov.uk

[Phillip Waddington Principal Technical Officer Streetscene 01484 221000](#)

phillip.waddington@kirklees.gov.uk

9. Assistant director responsible

Joanne Bartholomew – Assistant Director Place



Name of meeting: District Committee – Kirklees Rural Public Meeting

Date: 25th February 2017

Title of report: Mental Health First Aid Training

Is it likely to result in spending or saving £250k or more, or to have a significant effect on two or more electoral wards?	Not applicable
Is it in the Council's Forward Plan?	Not applicable
Is it eligible for "call in" by Scrutiny?	Yes
Date signed off by <u>Director</u> & name	Jacqui Gedman Rory O'Connor on behalf of Rachel Henshall Spencer, Director of Public Health
Is it signed off by the Director of Resources?	Debbie Hogg
Is it signed off by the Assistant Director – Legal, Governance & Monitoring?	Julie Muscroft
Cabinet member portfolio	Councillor Viv Kendrick –Adults, Health and Activity to Improve Health

Electoral [wards](#) affected: Colne Valley, Denby Dale, Golcar, Holme Valley North, Holme Valley South, Kirkburton

Ward councillors consulted: All Kirklees Rural

Public or private: Public

1. Purpose of report

To seek approval to allocate £14,000 New Homes Bonus funding to pay for mental health first aid training for community champions.

The training will equip participants to recognise and respond appropriately to signs of mental ill health and raise awareness of the range of local provision available to support 'at risk' individuals, and how this can be most effectively accessed.

2. Key points

2.0 Background

Kirklees Rural District Committee has identified improving health and wellbeing as one of its' priorities, in particular young people's emotional health and wellbeing. This report proposes how the committee could take forward and make a positive contribution to the public Mental Health agenda within the Kirklees Rural District.

2.1 Mental health is defined as a state of well-being in which every individual realises his or her own potential, can cope with the normal stresses of life, can work productively and fruitfully, and is able to make a contribution to his or her community, (WHO, 2014). Half of all lifetime cases of mental illness begin by the age of 14 and 1 in 4 of us suffer from a mental health problem in the course of any given year (DH, No Health without Mental Health, 2011).

2.2 Mental health is everyone's business; just like physical health, we all have mental health, which can change over time, with periods where we may struggle and other times when we feel well (Mind, 2015). Public mental health interventions can play a role in improving the mental health of people across these different stages. Public mental health is concerned with preventing mental health problems from happening, by targeting the whole population and those at risk groups (those experiencing: stressful life events, unemployment, poor housing, social isolation and loneliness).

2.3 Current Living In Kirklees 2016 (CLiK Survey) -

Adults

Residents were asked 'which, if any, of the following health conditions or illnesses do you have or have you had in the last 12 months?' There were options of depression, anxiety or other mental health condition, so the responses to this question incorporated all of the above.

Self reported in CLiK Survey %	Kirklees	Colne Valley	Denby Dale	Golcar	Holme Valley North	Holme Valley South	Kirkburton
No Mental Health Conditions	69.1%	67.5%	75.3%	68.9%	74.0%	77.0%	73.7%
Mental Health Conditions	30.9%	32.5%	24.7%	31.1%	26.0%	23.0%	26.3%
Total %	100%	100%	100%	100%	100%	100%	100%

Those living with any mental health condition was highest in Colne Valley and lowest in Holme Valley South. If we look at anxiety and depression separately, it shows how self reported measures of these conditions is also highest in the same geographical areas within Kirklees Rural.

Anxiety	%
Kirklees	24.1%
Kirklees Rural	21.6%
Highest - Colne Valley	25.5%
Lowest – Holme Valley South	18.2%

Depression	%
Kirklees	21.7%
Kirklees Rural	17.3%
Highest - Colne Valley	22.1%
Lowest – Holme Valley North	13.8%

(It is important to note that these figures are not mutually exclusive, therefore one person could have ticked more than one mental health condition).

Young People

Kirklees Rural had the highest amount of young people reporting they have anxiety or depression at 1 in 29 (4%) young people and also the lowest wellbeing score out of the four District Committees. Overall for Kirklees, 1 in 20 (5%) young people have problems sleeping due to anxiety and this was higher in Kirklees Rural (1 in 17, 6%) than the other four District Committees. (Young Persons Survey, 2014)

Loneliness

Having a mental health problem increases your chances of feeling lonely and feeling lonely can have a negative impact on your mental health (Mind, 2013). Residents were asked in the CLiK survey 'Do you ever feel lonely or isolated where you currently live?'

Self reported in CLiK survey	2012		2016	
	Kirklees Rural	Kirklees	Kirklees Rural	Kirklees
Most/all of the time	3.8%	6.3%	4.6%	7.2%
Some of the time/not very often %	45%	48.1%	47.2%	51%
Never %	51.2%	45.7%	48.2%	41.8%
Total %	100%	100%	100%	100%

Kirklees Rural had lower reports of feeling lonely than the Kirklees average, therefore efforts should be focused on those areas with higher self-reported levels of mental health conditions as these people are more likely to feel lonely.

2.4 The Proposal

This proposal is to provide Mental Health First Aid Training (MHFA) and Youth MHFA for identified community champions working with those most at risk of developing mental health problems, including awareness raising of local provision amongst primary care.

Mental Health First Aid Training is an internationally recognised, accredited two-day course that teaches people how to recognise and respond appropriately to signs of mental ill health. The practical skills based approach demystifies mental health problems and challenges the stigma and discrimination that surrounds mental illness. Participants learn about anxiety, depression, psychosis and suicide, and they gain an understanding about risk factors, signs and symptoms.

At the end of the course delivered by Community Links, participants are able to:

- Recognise and respond appropriately to signs of mental ill health.
- Feel confident helping someone experiencing a problem.
- Help stop a mental illness from getting worse.
- Help someone recover faster.
- Guide someone towards the right support.
- Reduce the stigma of mental health problems.

The benefit in supporting the development of Kirklees Rural specific community champions, is the extensive understanding they will have about relevant local provision and how to access this. Details of local support opportunities will be shared and there will be follow up after the training as part of the evaluation, and to share case studies of what difference the training made.

A scope will be done of the best-placed individuals from across the district to attend the MHFA training. These individuals would need to be well known in the community and come across people at risk of developing or already experiencing early stage mental health conditions. They need to be in a position to have those 'conversations' with those living in the community who would benefit from some help. It is envisaged that a broad range of individuals will be identified from community and voluntary organisations and relevant services.

The work of the champions will be monitored, to look at what impact the training has had on their contacts and to ask for case studies for the difference the training has made. GP's will be notified that this training has taken place as they may observe an increase in people asking for help. There will be awareness raising of existing local level services to support those who may benefit from signposting to these services alongside treatment or instead of or as part of their recovery, and there will be the development of a leaflet that combines all services available and how to access them to hand out to communities where appropriate.

2.5 Cost breakdown

Item	Amount Requested from District Committee	Amount Funded from other sources	Total Cost
Mental Health First Aid Training – 128 places (adult/ young people’s cohorts/ 16 places per course)	£12,000	-	£ 12,000
Leaflet Print & Promotion	£500	-	£500
Room booking and refreshments	£1,500	-	£1,500
Total	£14,000	-	£14,000

These costs are based on the cost of the programme delivered in Dewsbury and Mirfield District as a pilot; where 128 champions will be trained. Four courses (16 people per course) relate to adult mental health and four relate to youth mental health (16 people per course).

2.6 Timescales

The training would take place during 2017-18 on a rolling programme of 2-day sessions involving sixteen individuals per training course.

2.7 Commissioning

As three district committees are considering this proposal for their district and the total value will be above £20, 000 the training organisation will be selected via the Council’s procurement process, which has potential to reduce costs.

2.8 Expected outcomes and benefits

Improved emotional health and wellbeing for those living in Kirklees Rural.

Increased awareness and understanding of mental health: by public and front line staff (housing, primary care staff, neighbourhood management groups, youth workers etc).

Local communities and organisations learn how mental health conditions affect others, reducing stigma and creating a mentally healthy community.
More people living well in their community.

MHFA and youth MHFA will be delivered to communities of interest e.g. faith groups, older peoples groups, primary care, workplaces, the community and voluntary sector, to increase basic awareness and understanding of mental health conditions and more importantly what can be done to help.

Partnership working and co-ordinated approaches to improving mental health through raising awareness of existing local community and voluntary mental health services.

Specific work with GPs in the area to promote social prescribing to local mental health services, especially for those already in contact with GPs for their mental health condition.

2.9 Other agencies or services involved:

Greater Huddersfield Clinical Commissioning Group, General Practitioners, wide range of community based community and voluntary sector groups, and frontline staff working in local communities.

2.10 New Homes Bonus criteria

The proposal meets the criteria:

- a. *Funding is used to help deliver priorities and actions contained in the Early Intervention & Prevention and Economic Resilience work programmes that are evidence based.*
- b. *Projects demonstrate innovation, new ways of working, encourage partnership involvement and deliver benefits across several wards.*

3. Implications for the Council

This project proposal meets the following priorities for the Council and for the District Committee:

Health and Wellbeing and Early Intervention and Prevention.

The project will support those people at risk of developing mental health problems (including children), as well as those who might already be experiencing early stage mental health problems.

MHFA has existed for many years but this project aims to take mental health awareness as upstream as possible, for people to identify signs and symptoms as early as possible and take action, helping people to help themselves.

This programme has no identified negative impacts and no legal, financial, IT or HR implications for the Council. The programme will enhance life chances for young people.

4. Consultees and their opinions

This programme has been developed through involvement from Public Health Improvement Practitioners.

Kirklees Rural Councillors.

5. Next steps

If funding is approved potential participants/ champions will be scoped, dates will be arranged and recruitment for participants will take place.

6. Officer recommendations and reasons

To consider the proposal and make a decision as to whether to support the application and allocate funding.

7. Cabinet portfolio holder recommendation

Not applicable.

8. Contact officer and relevant papers

Rebecca Elliott
Health Improvement Practitioner Advanced
Public Health Directorate
Tel:01484 221000
Email: rebecca.elliott@kirklees.gov.uk

9. Assistant director responsible

Rachel Spencer –Henshall, Director of Public Health



Name of meeting: District Committee –Kirklees Rural Public Meeting

Date: 25th February 2017

Title of report: Community physical activity programme 2017-18

Is it likely to result in spending or saving £250k or more, or to have a significant effect on two or more electoral wards?	No
Is it in the Council's Forward Plan?	No
Is it eligible for "call in" by Scrutiny?	Yes
Date signed off by <u>Director</u> & name	Jacqui Gedman Kim Brear, Streetscene and Housing
Is it signed off by the Director of Resources?	Debbie Hogg, 21 st November 2016
Is it signed off by the Assistant Director – Legal, Governance & Monitoring?	Julie Muscroft, 21 st November 2016
Cabinet member portfolio	Not Applicable

Electoral [wards](#) affected: Golcar, Colne Valley, Holme Valley North, Holme Valley South, Kirkburton, Denby Dale

Ward councillors consulted: All Kirklees Rural

Public or private: Public

1. Purpose of report

To seek approval for £15k New Homes Bonus funding to develop and deliver a series of activities in the Kirklees Rural wards in 2017/18.

This will include introductory sessions to exercise including dancing, walking, running, cycling, fitness classes and sporting activities for beginners and families. Festivals will be put on to promote and celebrate being physically active.

2. Key Points

2.1 Background and Project Objective:

Our objective is to support and encourage children and adults leading sedentary lifestyles to take part in outdoor and indoor exercise to benefit their physical and mental health and sense of wellbeing. We believe that by taking part in physical activity and sharing positive experiences that people will strengthen their connections with their family, friends and local community.

We will focus the project on targeting currently inactive people:

- to engage them in physical activity
- to raise awareness of opportunities to participate
- to identify people in communities to take a leadership role to sustain the activity.

2.2 Evidence Base *(from the Joint Health & Wellbeing Strategy and Everybody Active Strategy)*

Around one in three people across Kirklees are classed as “inactive”, doing less than 30 minutes of physical activity per week. We know there are major health gains to be made from the move from inactivity to doing some activity in a week.

The number of women participating in sport and active recreation is low and appears to be declining. There is also low participation by those on low incomes.

There are inequalities in participation with lower socio-economic groups being less active, activity reduced with age, and women less active than men. Those who were more likely to be inactive included those with poor health and those claiming income related benefits. Tellingly, people who were obese were twice as likely as those who were a healthy weight to be inactive.

2.3 Project Outline:

2.3.1 Scope of activity and venues:

We propose organising a series of beginners / taster events specifically in the Rural District which will include Dancing, Walking, Running, Cycling, Walking Football, Tennis, various Sports and Exercise classes with a focus on building people’s confidence and ability to exercise and to be more active.

We will deliver festivals, to promote and celebrate this programme. These events will bring participants and providers together to share experiences, have fun and build links between groups and establish regular sessions.

We will use our existing green spaces (playing fields, woodland areas) to organise walks, runs and cycle rides and develop activities with local organisations in venues such as KAL, sports clubs and community centres, outdoor spaces.

A mapping exercise will be carried out to identify current opportunities and then the programme will be developed on a ward basis with councillors, partners and interested community members and groups.

We will organise a number of activities and work with existing providers of community activity to encourage people to engage with exercise opportunities and support individuals to take up training.

Working with KAL we will identify organisations to work with, and specific individuals, who are leaders within their communities/ social groups to promote uptake of organised walks, runs, rides, sports and exercise.

2.3.2 Expected outcomes:

- Engage new people in dancing, walking, cycling, jogging, exercise and sport; encourage them to adopt behaviours in daily lives, e.g. active travel to get to school, shops, services, and regular participation in exercise.
- Introduce sense of fun in taking part in activities and enjoying the great outdoors and local indoor facilities.
- People exploring their local neighbourhoods
- Identify activity 'leaders' and train them to organise activity
- People joining clubs and accessing existing opportunities

2.4 Cost breakdown:

- £10,000 will support different activities in 6 wards delivered by local providers. As required by the organisation delivering the session to cover venue hire, instructor costs, volunteer expenses or equipment as required.
- £2,000 for festivals
- £2,000 for marketing and promotion
- £1,000 for follow on leadership training for volunteers

Number of beneficiaries approximately 10 per session (120 in total)

Funding will be used to commission activities, pay activity leaders, hire venues, provide refreshments, organise publicity and promotion, train new activity leaders and buy equipment.

Through alignment with other programmes of activity we expect officer support from key partner organisations and contributions from volunteers to develop activity and offer mutual support and promotion across the different activity areas and themes.

2.5 Volunteers

As an estimate based on 2 volunteers per session and 2 sessions per ward x 6 = a minimum of 24 volunteers will be involved over a 4 week period = 96 hours, this is a conservative guess. This is dependent on how many sessions are run by volunteers versus paid deliveries and how many sessions they would like to run.

2.6 Evaluation:

We will use participant questionnaires and evaluation tools developed for existing physical activity/behaviour change projects, e.g. Cycle for Health / Healthy Walking / England Athletics / Sports Clubs. We will collect participant contact details to allow for follow-up evaluation.

2.7 Sustainability:

There are existing programmes of community activity and more formal clubs to which we can signpost new participants:

Walking: Healthy Walking programme – Nordic Walking – Buggy Movers

Running: 3-2-1; Jog Kirklees; Parkrun

Cycling: Sky Ride programme (Sky Ride Local – Breeze – Ride Social)

Sports clubs

Kirklees Active Leisure - KAL

3. Implications for the Council

- There are no specific legal, financial, human resources (HR) or information technology (IT) implications of this project apart from these additional areas which will be incorporated within Council officer support. Support from Marketing and Communications
- Web Development
- Good will and some organisational input from council colleagues

What is the impact on the Council's priorities? The initiative supports:

- Everybody Active Strategy
- The developing Kirklees Walking and Cycling Delivery Plan
- Joint Health and Wellbeing Strategy
- Sport England's Strategy
- National Governing Bodies Strategies.

Will deliver against these council priorities:

- enhance life chances for young people
- support older people to be healthy, active and included

No specific climate change adaptation responses are required other than being prepared to accommodate/ plan around bad weather for outdoor activities.

Equality impact statement:

Activities will be planned to be as inclusive as possible. For example, we have local providers of inclusive cycling, walking and jogging activities, inclusive clubs. All activity will promote equality of opportunity and seek to create good relations between different people.

New Homes Bonus Criteria:

The proposal meets the following criteria –

- a) Funding is used to help deliver priorities and actions contained in the Early Intervention & Prevention and Economic Resilience work programmes that are evidence based.
- b) Projects demonstrate innovation, new ways of working, encourage partnership involvement and deliver benefits across several wards.

District Committee Criteria:

The proposal meets the district committee criteria of Health and well-being; access to physical activity in local communities.

4. Consultees and their opinions

The following organisations have contributed to and supported the development of this proposal:

Sport and Physical Activity Development Officers, KAL Community and Leisure Officers. They recognise the value of developing grass-roots physical activity in the heart of communities and making it sustainable by linking to existing programmes of activity.

5. Next steps

If funding is confirmed a planning meeting with the key partners will be organised to:

- Commission and plan the activities through meetings with ward Councillors, local organisations and volunteers
- Organise engagement with community representatives linking in with the community engagement team, IYSS and local VCS officers
- Develop publicity and promotion using the Try It branding, social media, leaflets and posters
- Organise training courses as identified by the volunteers and organisations involved in the delivery of this programme.

Elected members will be kept informed of project progress.

6. Officer recommendations and reasons

That the District Committee approves the request for £15k New Homes Bonus funding for this programme of activity. The project will meet the District Committee priority of Health and well being; access to physical activity in local communities. It will also help to meet Kirklees strategic priorities.

To invite elected members to support, promote and get involved in the programme of activity.

7. Cabinet portfolio holder recommendation

Not applicable

8. Contact officer and relevant papers

Claire Howe Tel. 01484 221000 ext. 77779

Claire.howe@kirklees.gov.uk

Background papers:

Everybody Active - Kirklees Physical Activity and Sport Strategy 2015 – 2020

<https://www.kirklees.gov.uk/leisure/sporthealth/pdf/EverybodyActiveStrategy.pdf>

9. Assistant Director responsible

Kim Brear, Assistant Director, Streetscene and Housing Tel 01484 221000

Kim.brear@kirklees.gov.uk



Name of meeting: District Committee – Kirklees Rural Public Meeting

Date: 25th February 2017

Title of report: Marsden Skatepark

Is it likely to result in spending or saving £250k or more, or to have a significant effect on two or more electoral wards?	Not applicable
Is it in the Council's Forward Plan?	Not applicable
Is it eligible for call in by Scrutiny?	Yes
Date signed off by <u>Director</u> & name	Jacqui Gedman, 13/02/17 Joanne Bartholomew, 13/02/17
Is it signed off by the Director of Resources?	Debbie Hogg (Jon Haigh 07/02/16)
Is it signed off by the Assistant Director – Legal, Governance & Monitoring?	Julie Muscroft (Andrew Hoyle 07/02/16)
Cabinet member portfolio	Cllr M Khan, Highways and Neighbourhoods

Electoral [wards](#) affected: Colne Valley

Ward councillors consulted: Donna Bellamy, Nicola Turner and Rob Walker

Public or private: Public

1. Purpose of report

To consider allocating £25k New Homes Bonus funding towards the building of a wheelchair friendly skatepark for use by young people and families across the Colne Valley and wider area at the Old Goods Yard in Marsden.

2. Key points

2.0 A group of 20 young people (mainly from Marsden village), supported by Communities Who Can, got together in Autumn 2015 to discuss provision of a skatepark for the Colne Valley area.

- 2.1** The proposal has progressed since then. Planning permission was granted in November 2016 for a skatepark to be built at the Old Goods Yard. The young people's group has been working with the local community for 12 months to raise funds and build support for the scheme in Marsden and the Colne Valley.
- 2.2** The facility will be used for skating, scooting and BMXing. The village of Marsden will benefit from the addition of a community facility. Young people and families who enjoy wheeled sports such as skating, bmx and scooters will benefit from a local facility. It would enhance the existing multi-use games area (MUGA) facility at the Goods Yard and be a well designed meeting place for local young people. The nearest skatepark is currently in Meltham and as such the local young people skate on the streets/ churchyard in Marsden when they are unable to travel over there. The skatepark will be accessible and the youth group will continue to develop the site, alongside the new partner organisations they have now developed good relations with, to include a bmx/ off-road track, suitable for use by hand bikes (Experience Community CIC www.experiencecommunity.co.uk).
- 2.3** The Old Goods Yard is an under used resource. The project will improve it and develop a broader community facility which does not impact detrimentally on existing local residential areas or village facilities. A condition of the Planning permission was that the existing teen shelter at the site be removed which will provide a safer more open site. A Copy of the site plan is attached.

2.4 Cost Breakdown

Item – to put in place the concrete infrastructure and ramps	Amount requested from District Committee	Amount funded from other sources	Total Cost
Planning Permission			£600
Construction	£25k	£40k	£65k
Contingency, contaminated land, moving earth	-	£3k	£2.4k
Excavation	-	£3k	£3k
Drainage	-	£3k	£3k
Design work	-	£6k	£6k
Total	£25k	£55k	£80k

An outline application made by Communities Who Can for match funding of £50k has been approved by the Veolia Trust. A stage 2 application will be submitted in April 2017 and a decision will be made on 2nd June 2017.

The young people's group has so far raised £5k towards the cost of the build of which they have already paid towards the plans being draw up and the planning permission application. They will continue to fund raise

and apply for grants to improve the facility for example for improved lighting, benches, storage, possible bmx track and outdoor movie shows.

2.5 Timescale

Subject to the above funding being in place by early June 2017, it is anticipated that the successful contractor will be in place by October 2017. The design elements of the site will be done, with the involvement of the young people, over Autumn 2017, with work starting with the better weather in Spring/Summer 2018 and taking approximately 3 months.

2.6 Volunteers

The young people involved have volunteered approximately 168 hours to date, organising events and taking part in fundraising activity in the local community; clean ups, planting, coffee mornings, promoting what they are doing (presenting at school and district committee meeting), developing their skills as community leaders.

2.7 New Homes Bonus Criteria

The proposal meets the New Homes Bonus criteria: -

- a. *Funding is used to help deliver priorities and actions contained in the Early Intervention and Prevention and Economic Resilience work programmes that are evidence based. Example - Refurbishment of existing play areas to improve quality of provision and encourage use.*
- b. *Projects demonstrate innovation, new ways of working, encourage partnership involvement and deliver benefits across several wards.*

In addition the project meets the District Committee priorities of Health and well being; access to physical activity in local communities and Place; communities looking after local assets for all to use and enjoy.

2.8 New Homes Bonus Criteria and Sustainability

- h. *Funding should not commit the Council to any future maintenance liability, unless a 5 year commuted lump sum is included in the budget.*

The main material will be concrete which has a 20-25 year life expectancy and is easy to maintain.

The Multi-use games court on-site currently has a maintenance regime in place – the rubbish bin is emptied and the site is swept as part of existing rounds. From experience, facilities such as these experience problems with litter (not helped by the windswept location). Cleansing Services have recommended that a trade waste bin would be needed and have indicated this could be incorporated into an existing round. There is also the potential to discuss with the National Trust the shared use of their facilities.

3. Implications for the Council

The land is owned by Kirklees Council. The proposals will help to develop the currently under-utilised site into a destination skate park and contribute further, to the facilities provided at the Old Goods Yard whilst also helping to fulfil all four Kirklees priorities including the Joint Health and Wellbeing Strategy Vision which promotes:

‘Open spaces and green infrastructure that encourage physical activity and support positive emotional wellbeing.’

The facility will bring more people to the site, potentially creating more rubbish/litter which will need collecting and disposing. The users already do a lot of work keeping the facility clean and tidy, something they have assured us will continue, there will still be a need for the rubbish to be collected and disposed. As mentioned above, the site is already part of a maintenance route and there is potential to discuss sharing refuse facilities with the neighbouring National Trust building.

Also mentioned above, the existing MUGA next to the proposed site which is already included within the current maintenance routes of the play area inspection team, the design and construction of the facility will be a concrete construction which will require very little maintenance.

4. Consultees and their opinions

Ward councillors Donna Bellamy, Nicola Turner and Rob Walker are supportive of the project. They have met with the skatepark group a number of times since it formed in Autumn 2015 to help progress the proposal with the Council.

5. Next steps

If funding is approved then the next step will be to submit the full application for match funding to the Veiola Trust. Part of the Veiola Trust application process is that match funding be in place when the full application is considered.

6. Officer recommendations and reasons

The Committee is asked to approve the allocation of £25k New Homes Bonus funding towards the building of a wheelchair friendly skatepark for use by young people and families across the Colne Valley and wider area at the Old Goods Yard in Marsden.

The project will meet the District Committee priorities of Health and well being; access to physical activity in local communities and Place; communities looking after local assets for all to use and enjoy. It will also help to fulfil all four Kirklees priorities including the Joint Health and Wellbeing Strategy Vision.

7. Cabinet portfolio holder's recommendations

Not applicable

8. Contact officer and relevant papers

Julie McDowell, Area and Neighbourhood Co-ordinator,

Tel 01484 221000

email: julie.mcdowell@kirklees.gov.uk

Emma Mills, Landscape Architect Manager, Streetscene and Housing

Tel 01484 221000

email: emma.mills@kirklees.gov.uk

Tilly Hall, Parks Development Officer, Streetscene and Housing,

Tel 01484 221000

email: tilly.hall@kirklees.gov.uk

9. Assistant director responsible

Joanne Bartholomew, Place – Physical Resources and Procurement

Report 16

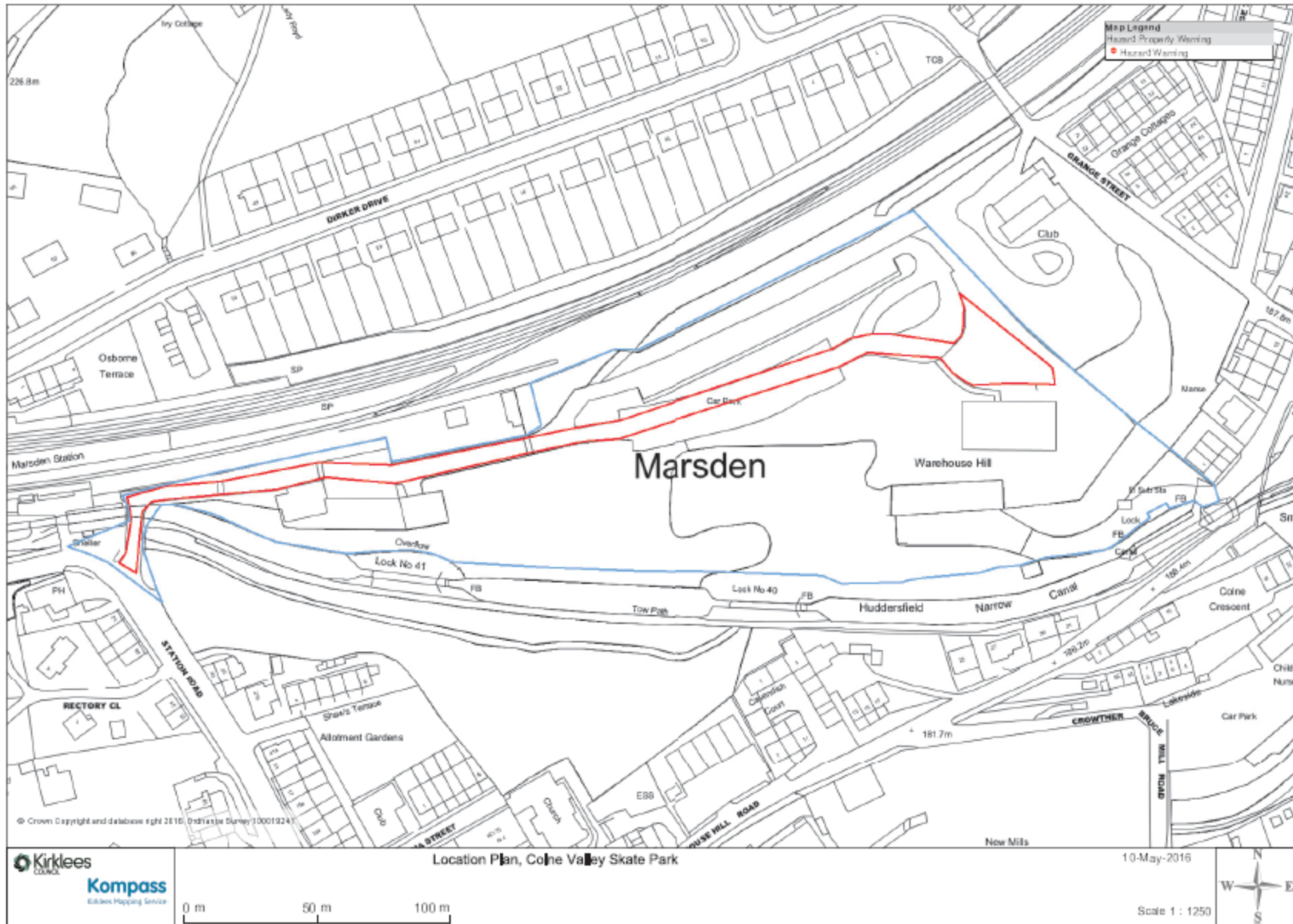



CV
COLNE VALLEY
COUNCIL



**MARSDEN
GOODS YARD**

Proposed Location
of Skate Park

Existing Features
Court retained



Proposed Location
of Skate Park

Existing shelter
moved/removed

LOCATION



Proposed Location
of Skate Park

COLNE VALLEY SKATE PROJECT



Name of meeting: District Committee – Kirklees Rural Public Meeting

Date: 25th February 2017

Title of report: Denby Dale to Upper Cumberworth path improvements

Is it likely to result in spending or saving £250k or more, or to have a significant effect on two or more electoral wards?	Not applicable
Is it in the Council's Forward Plan?	Not applicable
Is it eligible for “call in” by Scrutiny?	Yes
Date signed off by <u>Director</u> & name	Jacqui Gedman Joanne Bartholomew
Is it signed off by the Director of Resources?	Debbie Hogg
Is it signed off by the Assistant Director – Legal, Governance & Monitoring?	Julie Muscroft
Cabinet member portfolio	Councillor Musarrat Khan – Highways and Neighbourhoods

Electoral [wards](#) affected: Denby Dale

Ward councillors consulted: Councillor Graham Turner, Councillor Jim Dodds, Councillor Michael Watson

Public or private: Public

1. Purpose of report

1.1 To consult with councillors on a project to upgrade the surfacing and drainage of a footpath in Denby Dale.

1.2 To request Councillors agree to provide £27,000 New Homes Bonus funding delegated to Kirklees Rural District Committee.

2. Key points

2.1 The project plans a major improvement to a route linking Denby Dale railway station to Upper Cumberworth. Parts of the recorded public footpath (Denby Dale Nos 84 and 119) have become waterlogged and are almost impassable at times of the year. In better weather the path dries to a very uneven surface.

- 2.2** The path is part of the “Denby Dale to Shepley Trail”, waymarked by Denby Dale Walkers are Welcome Group and linking the 2 stations. Walkers Are Welcome is a locally focused national initiative aiming to encourage walking and improve facilities, bringing benefits to health, the environment and the local economy.
- 2.3** Denby Dale Walkers Are Welcome group have suggested moving the path from its current route, shown dashed X-X on the attached plan, to the route shown dotted Y-Y. This is because of the very poor condition of the current route and the drier, less convoluted route of the alternative.
- 2.4** To facilitate improvement work taking place on route Y-Y, the Council could consider:
- An application to divert the route X-X to Y-Y. This process is open to public consultation, may result in a public inquiry and has estimated costs of £2500 - £7500
 - Creation by agreement of a new path Y-Y and preferably extinguishment of the X-X route. The creation aspect may incur legal costs for the landowner. The extinguishment process is open to public consultation, may result in a public inquiry and has estimated costs of £2500 - £7500
 - Compulsory creation of a new path Y-Y and preferably extinguishment of the X-X route. Consultation takes place with other local authorities on the creation order, with the public on an extinguishment, may result in a public inquiry and has estimated costs of £2500 - £7500
 - Dedication of a public right of way by the landowner. The council would be likely to gain maintenance responsibility in addition to the existing path. Permission would be needed to carry out works
 - Permissive agreement with the landowner. A permissive agreement does not dedicate the route as highway (public footpath) and does not therefore gain the protection such designations provide. The Council would still have responsibility for the existing route X-X. Some legal costs may be incurred on both parties. Planning permission may be required
 - Permission of the landowner to construct the path with no formal agreement. The path would be provided but with no protection. Planning permission may be required.
- 2.5** Highways Act applications to divert or create a public right of way are assessed under a Cabinet approved priority scoring matrix. An application to divert the path, for example, may not score enough points to trigger starting the process.

2.6 It is understood that a new planning application has been made by the quarry owners in connection with restoration works. The proposed haulage road in this application forms part of the route on the recorded right of way. It is not known at this early stage how the footpath will be accommodated.

2.7 The proposal works towards the District Committee's Plan of Place vision: "To work in partnership with local communities, to plan how to make the district a better place for people to live, work and play, by building on its strengths, resources and assets", because it would provide better access along a promoted route which also links to the area's public rights of way network

2.8 This proposal contributes to the Plan of Place priorities of:

- Economic growth and regeneration – Tourism – local infrastructure and promoting attractions locally
- Health and Wellbeing – Young peoples' emotional health and wellbeing, Access to physical activity in local communities
- Place – Footpaths, roads and greenway improvement

2.9 The proposal would meet the New Homes Bonus fund criteria under the following headings:

- Economic Resilience 3.Support to VCS/Community to develop business planning skills
- Early intervention and prevention

2.10 The proposed works for the path are:

- Site preparation – remove vegetation as required, remove soft material to a sound base
- Lay textile membrane
- Lay a base layer of sandstone aggregate
- Lay a surface layer of sandstone aggregate
- Install stock fencing along the field path

2.11 The estimated cost of the project is approximately £27,000.

2.12 The amount requested from New Homes Bonus Kirklees Rural District Committee is £27,000.

3. Implications for the Council

3.1 Promoting and improving routes such as this works towards New Council aims such as improving health and wellbeing and increasing access between communities.

3.2 The West Yorkshire Local Transport Plan highlights maintenance and improvement to rights of way within its Delivering Accessibility, Tackling Congestion and Effective Asset Management themes.

3.3 Local users and those from further afield will benefit from a well-surfaced route which is unlikely to deteriorate for many years

3.4 As Highway Authority, maintenance of the surface of the existing public right of way will remain the responsibility of Kirklees Council. If this existing path is resurfaced the legal responsibilities of the Highway Authority continue unchanged. If a new path is created by agreement or by order and it is dedicated as a public right of way, its maintenance will be responsibility of the council. Its existence, and capital investment, is then protected by legislation. Other methods do not necessarily offer this protection. Details under point 2.4 above are also relevant here.

4. Consultees and their opinions

Ward councillors have been consulted on and support the proposals. Councillors would wish to see a conclusion to any legal issues associated with movement of the path before any works commence on site.

Public Rights of Way officers support this in principle.

Denby Dale Walkers Are Welcome Group support the proposals.

Denby Dale Parish Council support the proposals.

5. Next steps

5.1 Denby Dale Walkers Are Welcome Group need to consider the options available and the consequences on their proposal, in discussion with Public Rights of Way officers.

6. Officer recommendations and reasons

Officers recommend that members approve the proposed scheme for funding of £27,000 from New Homes Bonus. Officers recommend that the legal processes are complete before works commence. However, this may lead to the project becoming unachievable because:

- There could be legal processes to follow with an unknown completion date and which can take more than a year
- Which legal processes will be used is unclear at this point
- Any agreements with landowners have yet to be made
- A planning application has recently been made which significantly affects part of the route

7. Cabinet portfolio holder recommendation

Not applicable

8. Contact officer and relevant papers

Contact Officer: Andy Gardner 01484 221000

E-mail: andrew.gardner@kirklees.gov.uk

9. Assistant director responsible

Joanne Bartholomew, Assistant Director Place – Physical Resources and Procurement

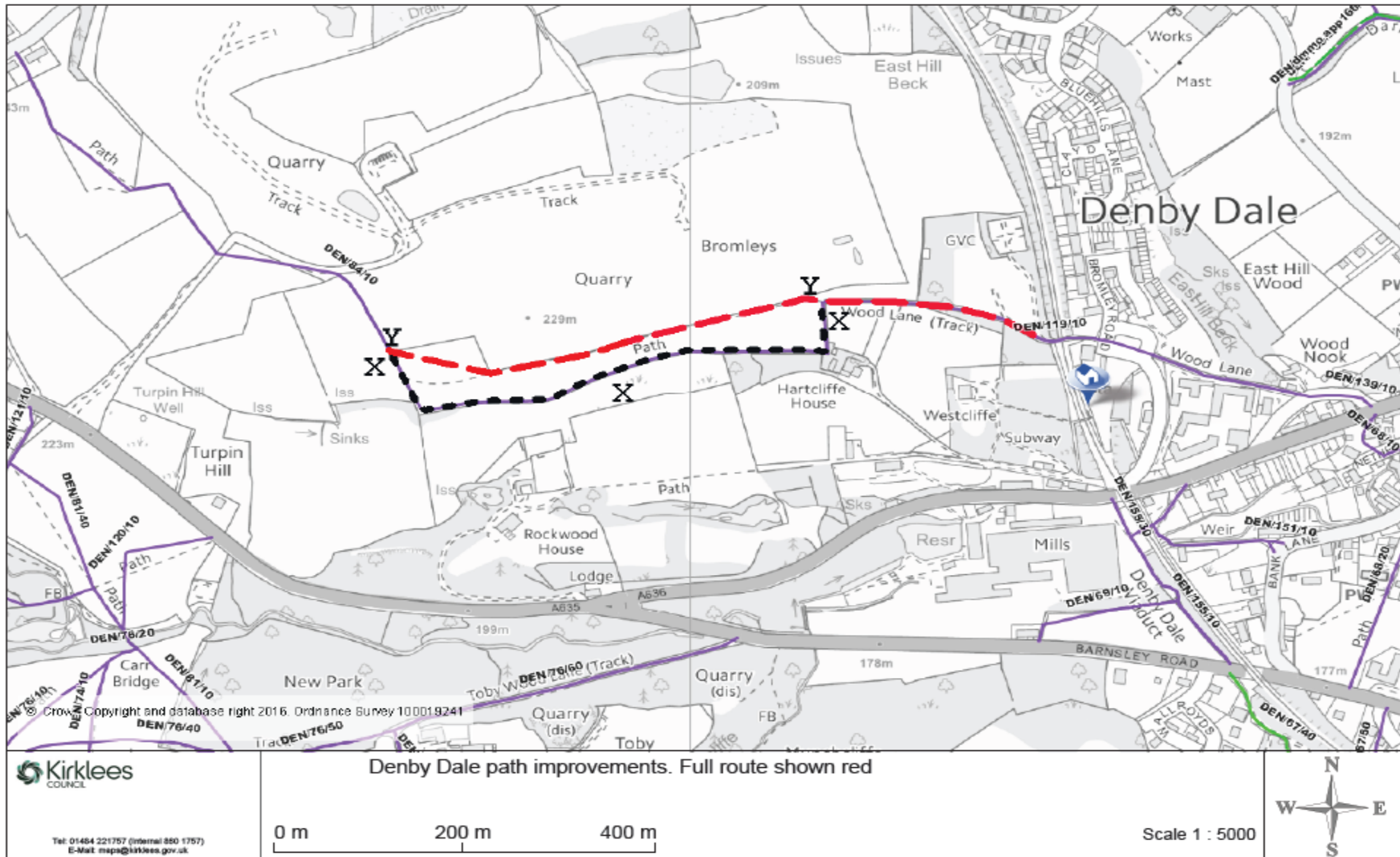



Name of meeting: District Committee – Kirklees Rural Public Meeting

Date: 25th February 2017

Title of report: Loan request re grant application to EPIP – Kirkburton Spur

Is it likely to result in spending or saving £250k or more, or to have a significant effect on two or more electoral wards?	Not applicable
Is it in the Council's Forward Plan?	Not applicable
Is it eligible for call in by Scrutiny?	Yes
Date signed off by <u>Director</u> & name	Jacqui Gedman
Is it signed off by the Director of Resources?	Debbie Hogg 13/02/17
Is it signed off by the Assistant Director – Legal, Governance & Monitoring?	Julie Muscroft
Cabinet member portfolio	Not applicable

Electoral [wards](#) affected: Denby Dale, Kirkburton

Ward councillors consulted: All Kirklees Rural

Public or private: Public

1. Purpose of report

The Committee is asked to consider a request from Denby Dale Walkers are Welcome Group to use £33,204 New Homes Bonus funding as a short term loan.

2. Key points

2.0 Denby Dale Walkers are Welcome Group has applied for a £33,204 grant from EPIP's LEADER programme 2015 -20. The funding will be used to improve the Kirkburton Spur of the Trans Pennine Trail at Long Lane, Thunderbridge and Bank Lane, Denby Dale.

2.1 The Group has also applied to the district committee for a grant of £8,252 as match funding for the work. This application is being considered at the committee meeting on 25th February 2017.

- 2.2** The EPIP funding application is being considered by the East Peak Board (Local Action Group) in February 2017. EPIP grants to charitable organisations can only be paid retrospectively - i.e. the grant can be claimed only after the work has been completed and the invoices settled. The work will involve reconstructing the bridleway and adding drainage at Long Lane and excavating a spoil, adding drainage and resurfacing at Bank Lane. Two preferred quotes have been selected from local contractors.
- 2.3** Subject to all the funding being in place the work is planned to take place in April 2017. The loan would be paid in April 2017 and would be re-paid to the Council in May 2017 when the EPIP grant of £33,204 is paid to the group.

3. Implications for the Council

Denby Dale Walkers are Welcome Group is registered with the Council's Grant Access Point. If this short term loan is approved the Group will enter into a agreement with the Council to repay it immediately on receipt of the EPIP grant.

All the work will take place on Public Rights of Way. Kirklees Public Rights of Way Team gives permission for the works on both sections of the route –“maintenance of the improved surface of the route will remain the responsibility of Kirklees Council, as Highway Authority, unless altered without permission by others.”

The application meets the district committee priority of Place; footpaths, roads and greenway improvements, Economic Growth & Regeneration; contributing to the rural economy and local tourism and Health and well being; access to physical activity in local communities. It supports the Council priorities of Early Intervention and Prevention and Economic Resilience.

New Homes Bonus Criteria met:

- a) Funding is used to help deliver priorities and actions contained in the Early Intervention & Prevention and Economic Resilience work programmes that are evidence based.
- b) Projects demonstrate innovation, new ways of working, encourage partnership involvement and deliver benefits across several wards.

4. Consultees and their opinions

Kirklees Rural Councillors have been consulted. Cllr John Taylor “This seems like a sensible solution to what is otherwise an intractable problem with scheduling the work to be done. So long as the correct processes are in place to recoup the monies promptly, I am happy to support this proposal.”

5. Next steps

The amount of £33,204 would be paid to Denby Dale Walkers are Welcome Group on receipt of written confirmation from EPIP of the grant award, on receipt of the signed agreement with the Council for the loan and on receipt of written confirmation of the timescale for the work.

EPIP have confirmed that the grant claim would be paid directly to Denby Dale Walkers are Welcome Group on submission of the receipts, which would then re pay the Council. The Rural Payments Agency have to pay the EPIP grant direct to the applicant.

6. Officer recommendations and reasons

The Committee is asked to consider approving a short term loan of £33,204 to Denby Dale Walkers are Welcome Group to facilitate improvements to Kirklees Bridleways.

Subject to receipt of written confirmation from EPIP of the grant award, to receipt of the signed agreement with the Council for the loan and on receipt of written confirmation of the timescale for the work.

7. Cabinet portfolio holder's recommendations Not applicable

8. Contact officer and relevant papers

Julie McDowell, Area & Neighbourhood Co-ordinator, Tel 01484 221000
email: julie.mcdowell@kirklees.gov.uk

9. Assistant director responsible

Kim Brear, Streetscene and Housing



Name of meeting: District Committee – Kirklees Rural Public Meeting

Date: 25th February 2017

Title of report: Colne Valley Bridleway No 197

Is it likely to result in spending or saving £250k or more, or to have a significant effect on two or more electoral wards?	Not applicable
Is it in the Council's Forward Plan?	Not applicable
Is it eligible for "call in" by Scrutiny?	Yes
Date signed off by <u>Director</u> & name	Jacqui Gedman Joanne Bartholomew
Is it signed off by the Director of Resources?	Debbie Hogg
Is it signed off by the Assistant Director – Legal, Governance & Monitoring?	Julie Muscroft
Cabinet member portfolio	Councillor Musarrat Khan– Highways and Neighbourhoods

Electoral [wards](#) affected: Colne Valley

Ward councillors consulted: Councillors Nicola Turner, Rob Walker and Donna Bellamy

Public or private: Public

1. Purpose of report

1.1 To consult with councillors on a project to continue surfacing a public bridleway running across open moorland with reclaimed mill flags and stone.

1.2 To request Councillors agree to provide £22,500 New Homes Bonus funding delegated to Kirklees Rural District Committee, with an intention that match funding be sought. Total cost of the scheme is £45,000.

2. Key points

- 2.1** Colne Valley Area Committee funded the purchase of materials in 2012/13 and 2013/14 financial years to begin work on this project. The National Trust, as landowner, organised and funded an airlift of the materials and provided volunteers to carry out the works. A reminder of the scheme details is provided in points 2.2 to 2.8 below. This section of the project is 330 metres in length and directly connects to previous works. This is shown Y-Y on the accompanying plan “Works Close Gate”
- 2.2** The bridleway, Colne Valley No 197, runs from Close Gate Bridge (also known as Eastergate Bridge), Hey Green at Marsden to Haigh Gutter on the A640 New Hey Road. The route is shown dotted X-X on the accompanying plan and is approximately 2.8 kilometres or 1.7 miles in length. As a public bridleway, the public have a right to walk and to ride a horse and can also use bicycles.
- 2.3** The bridleway is significantly damaged due to poor drainage, a high level of use and the lack of a durable surface. There are substantial lengths of braiding caused by users moving wider and wider to avoid mud or deep eroded channels.
- 2.4** There are links from CV197 to the Pennine Way and the Pennine Bridleway. Both these routes have significant numbers of users, many of whom require overnight stays. Better access along this bridleway to Marsden’s hospitality, other commercial activities and transport links would contribute to the local economy and tourism aspirations.
- 2.5** The land has several designations. It is a site of special scientific interest, SSSI, which gives UK statutory protection for the best examples of flora, fauna, geological or physiographical features. It is within the South Pennine Moors Special Protection Area due to its European importance for several upland breeding bird species and it is registered common land, almost all owned by The National Trust.
- 2.6** The works are:
- carry out drainage works to properly manage adjacent water flows
 - surface sections of the bridleway using recycled mill flags.
 - surface steep sections of the bridleway with stone pitching. This is a technique similar to laying setts but constructed to make non-regular steps
- 2.7** The works involve recognised materials and methods used, for example, by the North York Moors and Peak District National Parks and on National Trails such as the Pennine Way and the Cleveland Way.
- 2.8** Discussions have taken place with the National Trust, as landowner. The Trust can offer its volunteer team to assist with the airlifts, flagging and pitching.

2.9 The proposal works towards the District Committee’s Plan of Place vision: “To work in partnership with local communities, to plan how to make the district a better place for people to live, work and play, by building on its strengths, resources and assets”, because it would provide better access along a promoted route which also links to the area’s public rights of way network

2.10 This proposal contributes to the Plan of Place priorities of:

- Economic growth and regeneration – Tourism – local infrastructure and promoting attractions locally
- Health and Wellbeing – Young peoples’ emotional health and wellbeing, Access to physical activity in local communities
- Place – Footpaths, roads and greenway improvement

2.11 The proposal would meet the New Homes Bonus fund criteria under the following headings:

- **Economic Resilience 3.Support to VCS/ Community to develop business planning skills**

The project would be a partnership with The National Trust, which is a registered charity, and it would be their volunteers who would implement the practical works on the ground with technical assistance from the Council (PROW Streetscene). The value of volunteer labour on this project is approximately £40,000.

- **Early intervention and prevention**

The National Trust is promoted via its website, Facebook and Twitter. Together with the public’s right to use the bridleway, this encourages use of the route which works towards improving health and wellbeing, the refurbishment allowing a greater range of users due to better surfacing.

People dealing with mental health issues benefit from being outdoors. This is supported by evidence from the mental health profession such as “Feel better outside, feel better inside” Mind (2013), and “Let’s get physical” Mental Health Foundation (2013).”

Volunteering can help combat social isolation across all age groups and this project also brings with it the health advantages of appropriate physical activity.

- **The main outcomes and benefits of the project** The Pennine Way and Pennine Bridleway are routes of national importance. Those users can be funnelled via improvements to this route into the Colne Valley, bringing trade to the varied businesses of Marsden and beyond. Both these routes have significant numbers of users, many of whom require overnight stays.

Better access along this bridleway to Marsden's hospitality, other commercial activities and transport links would contribute to the local economy and tourism aspirations.

The refurbishment methods would largely involve pitching, a method of resurfacing steep slopes with re-used mill wall stone and flagging with re-used mill flags, linking back to the industrial heritage of the area. The improved surface would be easier and safer to use and would be virtually maintenance free.

3. Implications for the Council

- 3.4** Promoting and improving recreational routes such as this works towards Council priorities such as reducing our carbon footprint, working with partners to better use resources and deliver services in new ways, and supporting the elderly in being healthy, active and included.
- 3.5** Because the West Yorkshire Local Transport Plan proposes "investment in low-carbon methods of travel such as...walking and cycling, in order to define, develop and manage and develop networks and facilities to encourage cycling and walking", this proposal will form part of the council's contribution to that objective.
- 3.3** Using District Committee funding as match or seed can pull in further significant funding, for example from organisations such as Pennine Prospects, the appropriate lottery fund or the Landfill Communities Fund.
- 3.4** The legal status of the route remains unchanged. As Highway Authority, maintenance of the existing surface of the route is the responsibility of the Council. Maintenance responsibility for the new surfacing would remain with the council. However, this type of surfacing has been shown to require very little maintenance.

4. Consultees and their opinions

Councillors Nicola Turner, Donna Bellamy and Rob Walker have been consulted on and support the proposals.

The National Trust Marsden Moor Estate is a partner in the project and supports the proposals.

Public Rights of Way Officers support the proposals.

5. Next steps

A funding bid will be submitted to Pennine Prospects. Detailed costings will be prepared for that bid and a work programme developed in conjunction with the National Trust.

6. Officer recommendations and reasons

Officers recommend that members approve the proposed scheme from New Homes Bonus funding in the 2016/17 financial year.

The amount requested from Kirklees District Committee New Homes Bonus is £22,500 with a requirement that match funding be sought from the LEADER programme via Pennine Prospects. Total cost of the scheme is £45,000.

- This would allow further progress to be made on site and/or funding bids to be progressed.
- Improving the surface and drainage would be of benefit to existing users and encourage new use because the route would be solid and well defined
- This in turn can benefit the local economy by bringing more people into the area. Long distance users making overnight stops are a particularly important group to attract because of the relatively large spend compared to a day or half day trip.
- Because the surface is virtually maintenance free, future resource demands are negligible
- Use of the bridleway will be concentrated onto a single, robust line thereby reducing further erosion and allowing previously damaged areas to recover
- Vegetation alongside the first section of works is already recovering
- A contribution is made to the Council's input to MyJourney (West Yorkshire Local Transport Plan).

7. Cabinet portfolio holder's recommendations

Not applicable

8. Contact officer and relevant papers

Contact Officer: Andy Gardner Direct Dial: 01484 221000

E-mail: andrew.gardner@kirklees.gov.uk

9. Assistant director responsible

Joanne Bartholomew Assistant Director Place – Physical Resources and Procurement

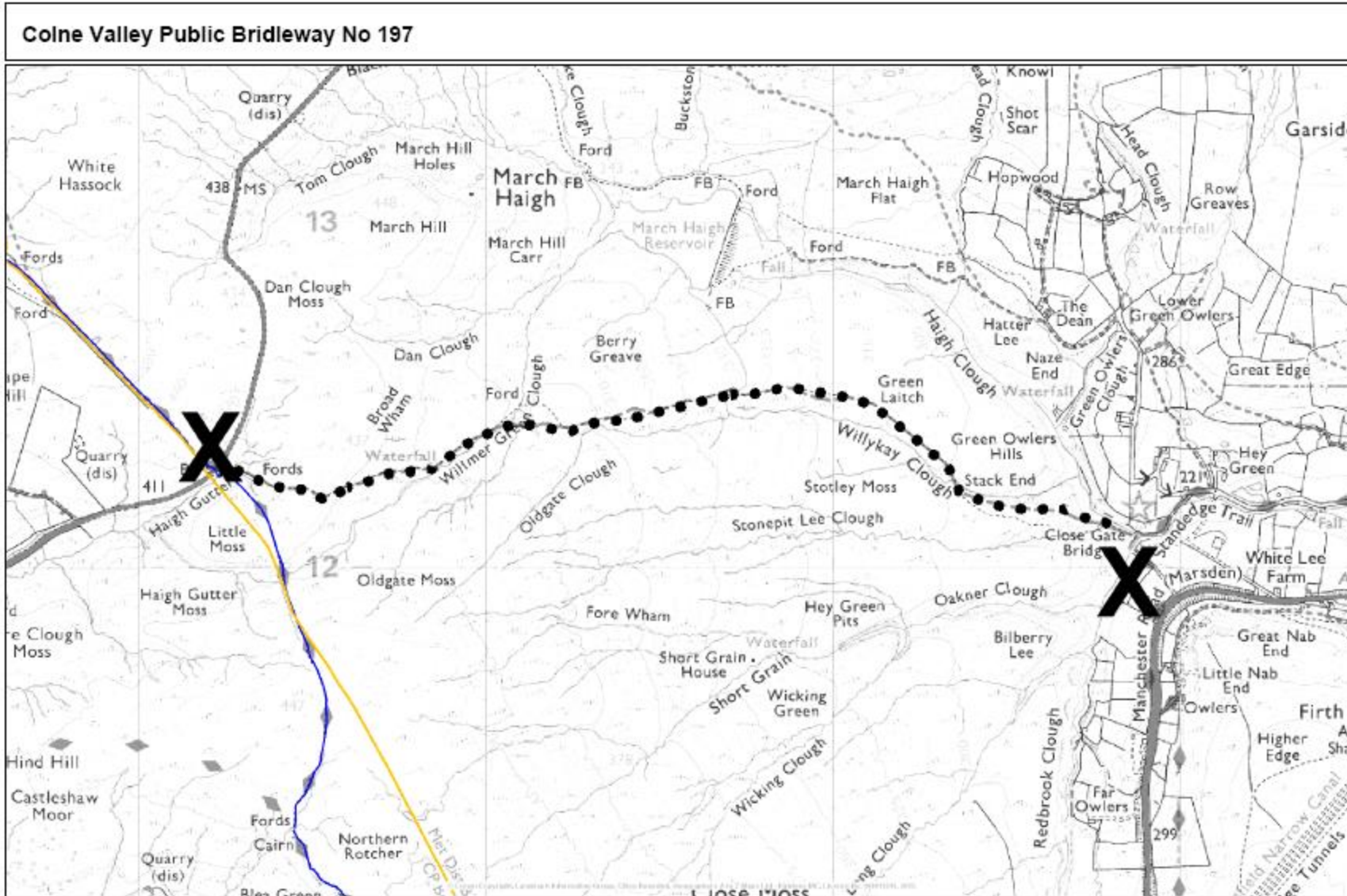

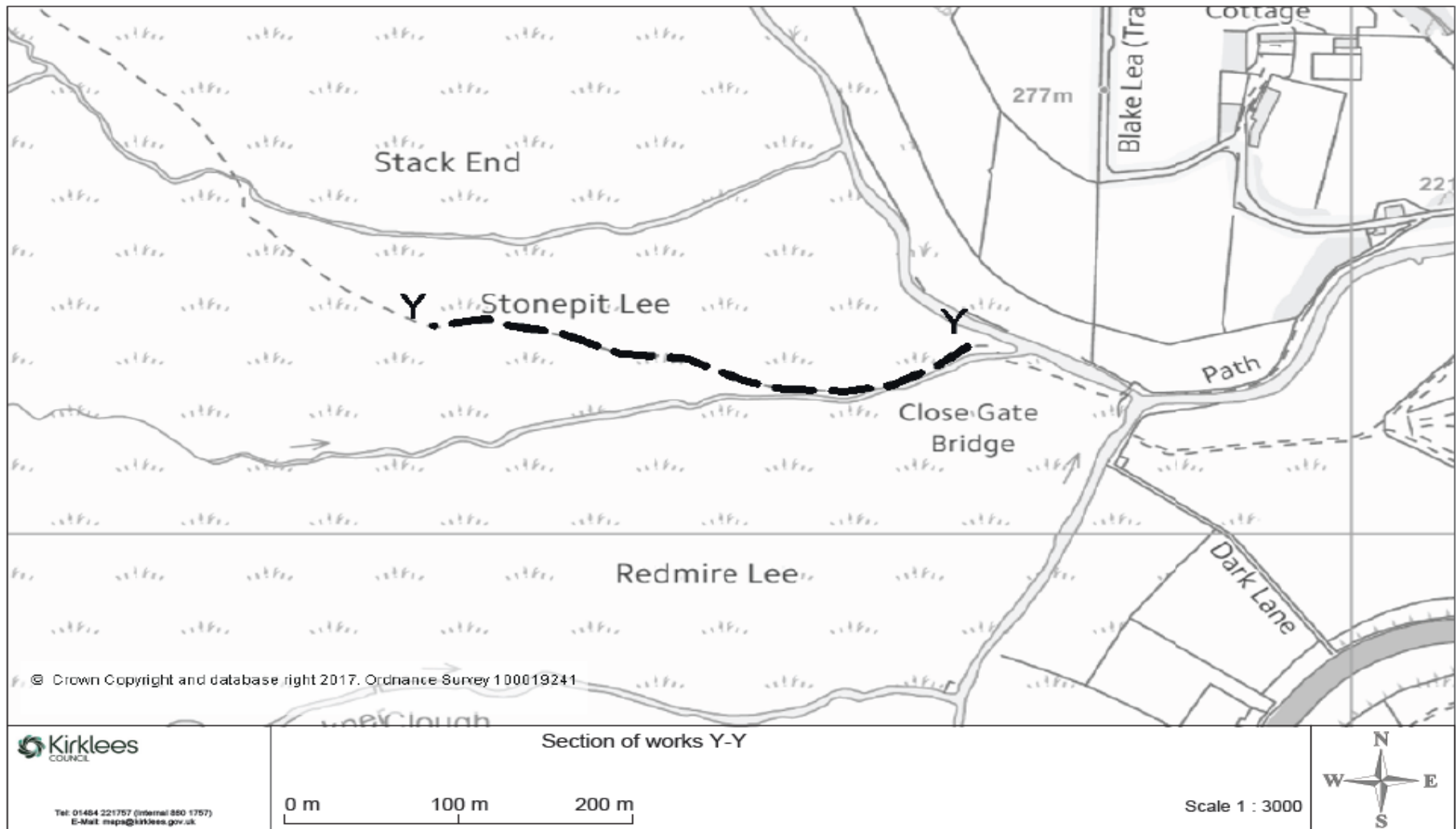



Name of meeting: District Committee – Kirklees Rural Public Meeting

Date: 25th February 2017

Title of report: Speed Limit Reduction Orders in Denby Dale and Kirkburton

Is it likely to result in spending or saving £250k or more, or to have a significant effect on two or more electoral wards?	No
Is it in the Council's Forward Plan?	No
Is it eligible for "call in" by Scrutiny?	Yes
Date signed off by Director & name	Jacqui Gedman 09/02/17 Joanne Bartholomew 09/02/17 Assistant Director Place
Is it signed off by the Director of Resources?	Debbie Hogg 09/02/17
Is it signed off by the Assistant Director – Legal, Governance & Monitoring?	Julie Muscroft, 08/02/17
Cabinet member portfolio	Councillor M Khan Highways and Neighbourhoods

Electoral [wards](#) affected: Denby Dale, Kirkburton

Ward Councillors consulted: Councillors Bill Armer, Jim Dodds, Graham Turner, John Taylor, Richard Smith and Michael Watson

Public or Private: Public

1. Purpose of report

To agree to commit New Homes Bonus funding of £52,000 to fund proposals for Speed Limit Reduction Orders (SLO) and other associated works in the Denby Dale and Kirkburton Wards.

2. Key points

To change the speed limits at the following locations:-

on the B6116 Huddersfield Road between Kirkburton and Shelley - reduce from national speed limit to 40 mph

on the A629 Abbey Road from Shelley Bank Bottom to The Knowle reduce from 40 to 30mph

on the A629 Lane Head Road Cliffe Road to Shepley Lane Head Farm increase from 30 to 40mph.

on the A629 Penistone Road through Birdsedge village - reduce from 40 to 30 mph.

Part of the existing 30 and 40mph speed limits on the A629 are to remain to complement the proposed changes.

Costs to include legal fees for Traffic Regulation Orders (TRO) for each scheme to advertise the changes complete with appropriate signing, lining, electrical connections/ disconnections at all of the sites.

New Homes Bonus Criteria

Funding will help to deliver an evidence based scheme which meets the priorities of the Early Intervention and Prevention and Economic Resilience programmes specifically –

Road Maintenance and Safety

- Maintenance to busy connecting roads affected by significant or multiple developments particularly during the construction phase which can be over a number of years.

3. Implications for the Council

There will be a future maintenance liability to the Council for the signing and lining which can be managed from within existing maintenance budgets.

4. Consultees and their opinions

Kirkburton Councillors are in support of the proposals as are the residents that attended a public meeting which was held at Shepley Library on 28th September 2016 which was attended by Highways Officers. The residents of Birdsedge and Shelley were also consulted by letter.

5. Next steps

Once funding is approved officers will commission the works.

6. Officer recommendations and reasons

Officers recommend that by funding this proposal the Kirklees Rural District Committee would demonstrate its continuing commitment to improving the safety & environment for road users and residents.

7. Cabinet portfolio holder's recommendations

Not applicable.

8. Contact officer and relevant papers

Aidan Hopson Principal Technical Officer Streetscene 01484 221000

aidan.hopson@kirklees.gov.uk

Phillip Waddington Principal Technical Officer Streetscene 01484 221000

phillip.waddington@kirklees.gov.uk

9. Assistant director responsible

Joanne Bartholomew – Assistant Director Place

Kirklees Rural District Committee Delegated Budgets:

Revenue:

	Carried Forward from 2015-2016	Allocation 2016-2017	Total Budget 2016-2017
Colne Valley	£15,890.03	£12,910.00	£12,348.03
Denby Dale	£5,558.49	£12,910.00	£12,828.49
Golcar	£7,222.09	£12,910.00	£14,397.09
Holme Valley North	£6,869.11	£12,910.00	£7,885.11
Holme Valley South	£28,726.77	£12,910.00	£40,023.77
Kirkburton	£1,088.88	£12,910.00	£7,218.88
Total	£65,355.37	£77,460.00	£94,701.37

Capital:

	Total Budget 2016 - 2017
Colne Valley	£6,138.42
Denby Dale	-£34.28
Golcar	£7,878.00
Holme Valley North	-£0.01
Holme Valley South	£0.53
Kirkburton	£0.61
Total	£13,983.27

New Homes Bonus:

	Allocated 2015-2016	Carried forward from 2015-2016 (roll-over)	Allocation 2016-2017	Total Budget Remaining
Kirklees Rural District Committee	£150,084.00	£111,284.00	£175,203.00	£220,987.00
10% of 2015-2017 Allocation			£17,520.30	

Estates and Environmental Works Budget

	Rollover 2015-16	Allocation 2016-17	Total Available 2016-17	Total Budget Remaining
Kirklees Rural District Committee	£45,343.50	£97,179.00	£142,522.50	£1,248.50